

| REV. | DATE | DESCRIPTION |
|------|----------|-----------------------|
| NC | 08/10/99 | INITIAL RELEASE |
| A | 12/28/05 | UPDATE DRAWING FORMAT |

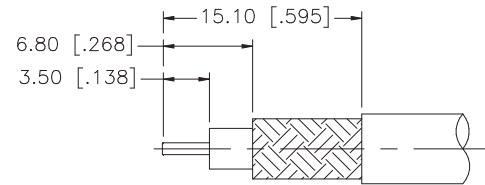

RECOMMENDED
CABLE STRIPPING DIM'S

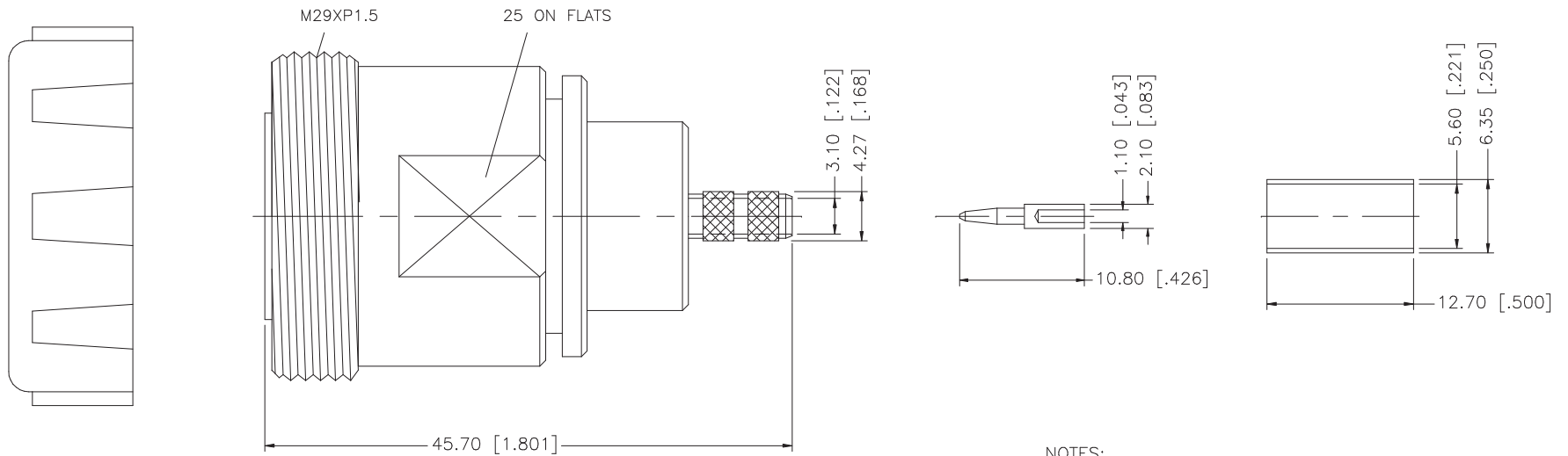

NOTES:

1. CRIMPED FERRULE
HEX CRIMP SIZE .213"
2. CRIMPED CONTACT PIN
HEX CRIMP SIZE .068"
OR CONTACT PIN TO SOLDER

| | | | | |
|---|-------------|----------|---------|-----|
| 8 | | | | |
| 7 | | | | |
| 6 | | | | |
| 5 | COVER | P.E. | BLUE | 1 |
| 4 | FERRULE | BRASS | NEXCOTE | 1 |
| 3 | CONTACT PIN | BRASS | SILVER | 1 |
| 2 | INSULATOR | TEFLON | NATURAL | 1 |
| 1 | BODY | BRASS | NEXCOTE | 1 |
| | DESCRIPTION | MATERIAL | FINISH | QTY |

UNLESS OTHERWISE SPECIFIED DIMENSIONS ARE IN MILLIMETERS. DIMENSIONS IN [] ARE IN INCHES AND FOR CUSTOMER REFERENCE ONLY.

UNLESS OTHERWISE SPECIFIED TOLERANCES FOR MILLIMETERS ARE:
0.5 - 8mm ± 0.20mm
8 - 30mm ± 0.40mm
30 - 120mm ± 0.50mm

UNLESS OTHERWISE SPECIFIED TOLERANCES FOR INCHES ARE:
.020 - .315 ± 0.007"
.315 - 1.180 ± 0.015"
1.180 - 4.724 ± 0.020"

DO NOT SCALE DRAWING

| APPROVALS | DATE |
|--------------|-------------------|
| DRAWN G.R.S. | 12/28/05 |
| CHECKED | |
| ISSUED | |
| SHEET 1 OF 1 | |
| CAD FILE | C:/272/272141.DWG |

Amphenol Connex

7/16 CRIMP JACK
(FOR RG-142A, 223/U, 400/U CABLE)

| | | | |
|--|------------|-------|----|
| PART DESCRIPTION | | | |
| 7/16 CRIMP JACK (FOR RG-142A, 223/U, 400/U CABLE) | | | |
| PART NO. 272141 | | | |
| DWG. NO. | 272141.DWG | REV. | A |
| SIZE | A | SCALE | NA |