

REV.	DATE	DESCRIPTION
A	01/07/04	REFORMAT DRAWING

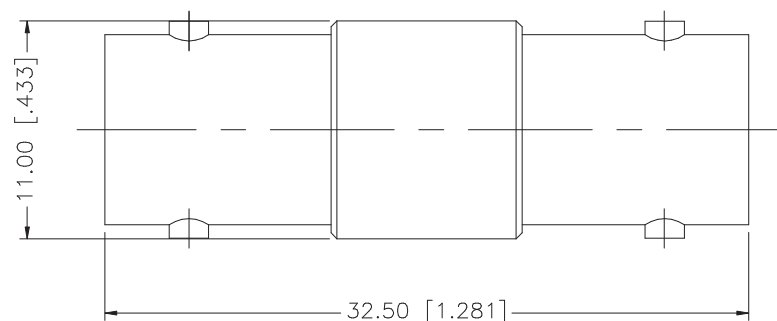

8					<small>UNLESS OTHERWISE SPECIFIED DIMENSIONS ARE IN MILLIMETERS, DIMENSIONS IN [ ] ARE IN INCHES AND FOR CUSTOMER REFERENCE ONLY.</small> <small>UNLESS OTHERWISE SPECIFIED TOLERANCES FOR MILLIMETERS ARE:</small> 0.5 - 8mm ± 0.20mm 8 - 30mm ± 0.40mm 30 - 120mm ± 0.50mm <small>UNLESS OTHERWISE SPECIFIED TOLERANCES FOR INCHES ARE:</small> .020 - .315 = ± 0.007" .315 - 1.180 = ± 0.015" 1.180 - 4.724 = ± 0.020"	APPROVALS	DATE	<h1 style="text-align: center;">Amphenol Connex</h1>					
7						DRAWN	G.R.S.					01/07/04	PART DESCRIPTION <h2 style="text-align: center;">BNC FEMALE TO FEMALE ADAPTER</h2> <h3 style="text-align: center;">75ohm</h3>
6							CHECKED		PART NO. <h2 style="text-align: center;">112446</h2>				
5							ISSUED						DWG. NO. 112446.DWG
4							SHEET	1 OF 1	REV.	A	SIZE	A	
3	CONTACT PIN	PHOS. BRONZE	GOLD	1		CAD FILE		C:/112/112446.DWG					
2	INSULATOR	DELIN	NATURAL	1		DO NOT SCALE DRAWING							
1	BODY	BRASS	NICKEL	1									
	DESCRIPTION	MATERIAL	FINISH	QTY									