

CAD DRAWING - NO MANUAL REVISIONS

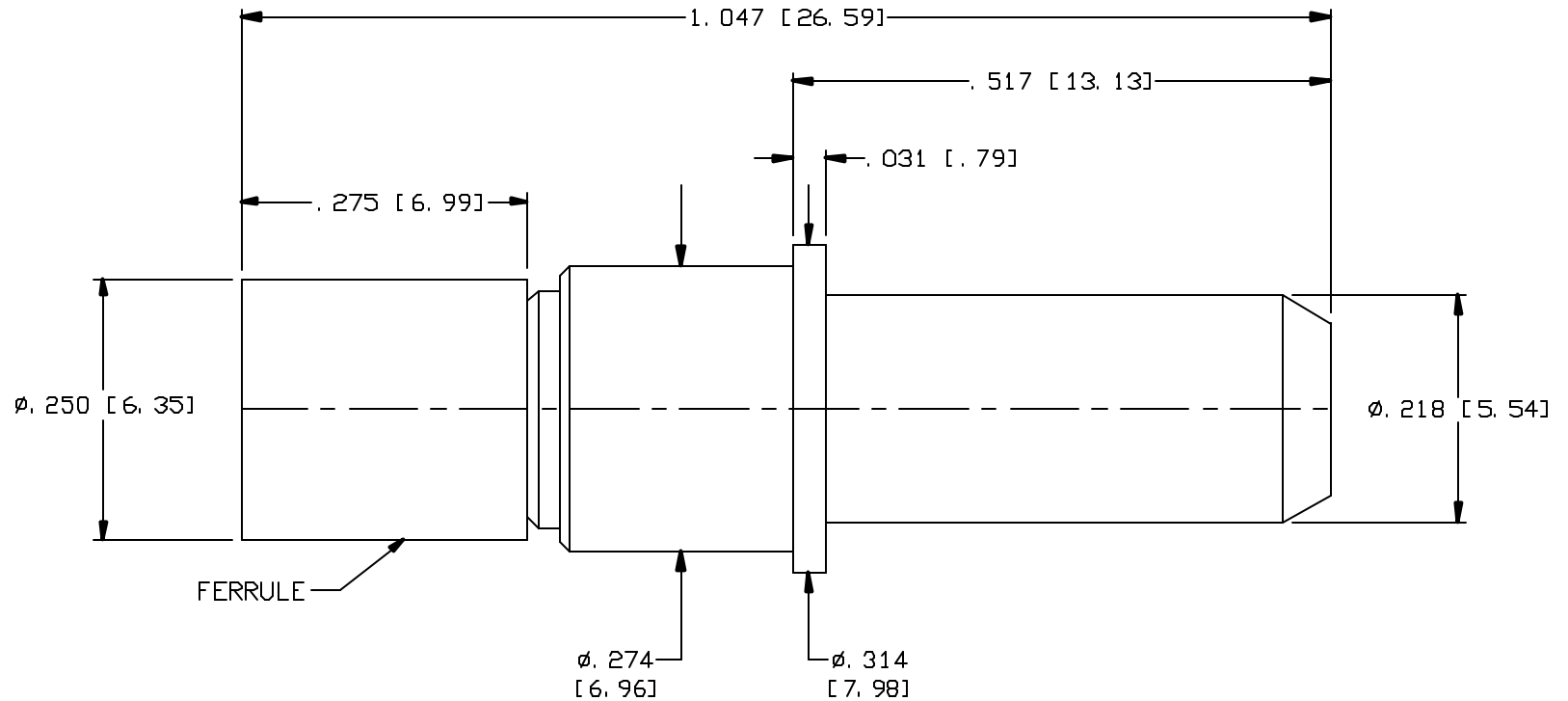

**NOTES:**

1. DESIGN AND INTERFACE PER I. D. S. -78.
2. DESIGN TO FIT MIL-C-38999, SERIES I, III & IV HOUSINGS.
3. FERRULE IS SHIPPED LOOSE.
4. ACCOMMODATES RG-142 D/S (M17/60) OR EQUIVALENT CABLES.
5. CRIMP WITH .213 HEX Y-197 DIE SET (M22520/5-05).

				<p><b>PALCO CONNECTOR</b></p> <p>22 GREAT HILL RD., NAUGATUCK, CT 06770</p> <p>UNLESS OTHERWISE SPECIFIED, PALCO WORKMANSHIP STANDARDS APPLY</p> <p>TOLERANCES ON: DECIMALS: XX ±.01 .XXX ±.005 ANGLES ±1/2° 32</p> <p>DIMENSIONS IN INCHES OR (METRIC) DO NOT SCALE PRINTS</p>	DRAWN EK	CHECKED JEM	ENGINEER EK	APPROVED JEM	FSCM 58167
B	PER ECN 11420	08/23/12	JEM			DESCRIPTION PKZ, PLUG, CRIMP TYPE			
A	PER ECN 9837	03/17/09	JEM		DATE 02/26/09	DRAWING NO. 78-0080-2201			PLATING OPT. A, B, C, D
REV.	DESCRIPTION	DATE	APPR.		FSR # 9105J				

THE INFORMATION IN THIS DOCUMENT IS CONFIDENTIAL AND PROPRIETARY AND MAY NOT BE USED FOR ANY PURPOSE WITHOUT THE WRITTEN CONSENT OF PALCO.