

CAD DRAWING - NO MANUAL REVISIONS

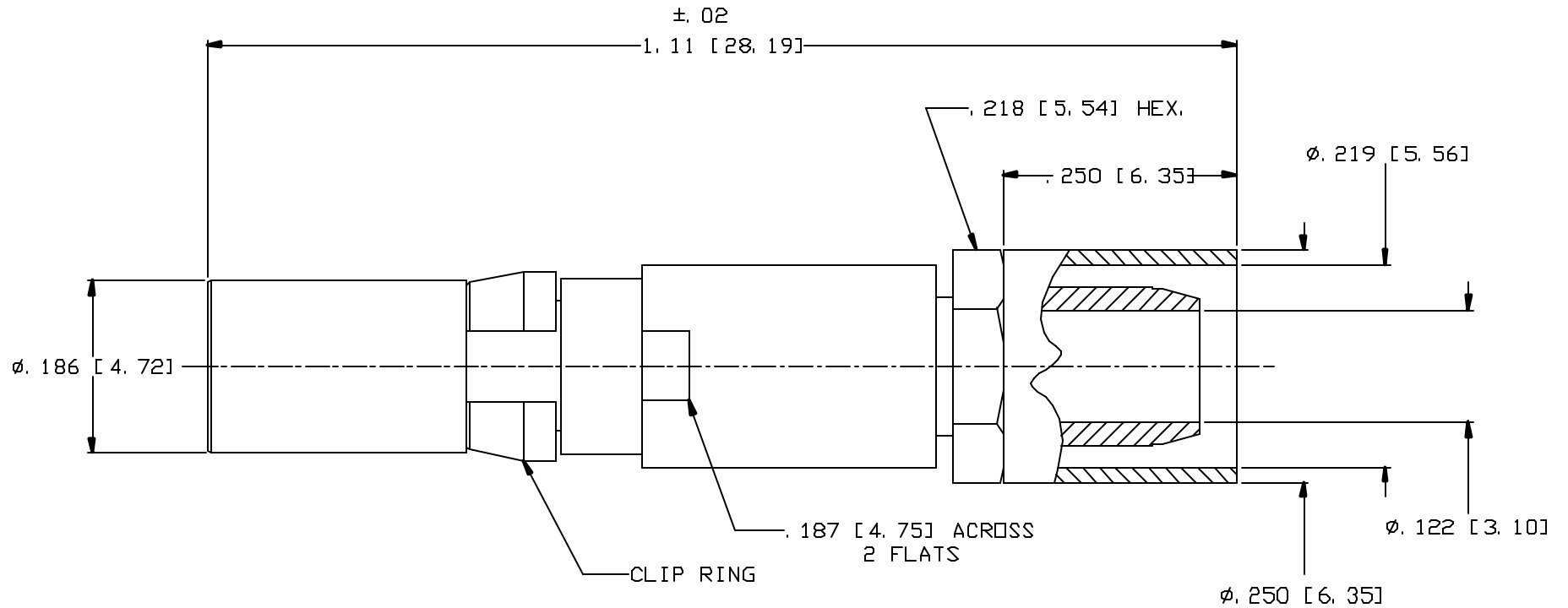

NOTES:

1. DESIGN AND INTERFACE PER I. D. S. -26.
2. FOR USE WITH RG 142 & 223 OR EQUIVALENT CABLES.
3. CRIMP USING .213 HEX DIE (M22520/5-05).
4. FERRULE & CRIMP NUT SHIPPED LOOSE.

L	PER ECN 10295	04/21/10	JEM	<b>PALCO CONNECTOR</b> 22 GREAT HILL RD., NAUGATUCK, CT 06770 UNLESS OTHERWISE SPECIFIED, PALCO WORKMANSHIP STANDARDS APPLY TOLERANCES ON: DECIMALS: XX ± .01 .XXX ± .005 ANGLES ±1/2° 32' DIMENSIONS IN INCHES OR (METRIC) DO NOT SCALE PRINTS	DRAWN MY	CHECKED HN	ENGINEER YT	APPROVED HN	FSCM 58167
K	PER ECN 9699	12/09/08	JEM			DESCRIPTION PKZ, RECEPTACLE, CRIMP TYPE			
J	PER ECN 5724	12/22/00	HN			DATE 11/23/88	DRAWING NO. 26-1080-1201	PLATING OPT. A, B, C, D	
I	PER ECN 4307	01/19/98	HN						
H	PER ECN 2893	05/02/95	HN						
REV.	DESCRIPTION	DATE	APPR.	CATALOG ITEM					

THE INFORMATION IN THIS DOCUMENT IS CONFIDENTIAL AND PROPRIETARY AND MAY NOT BE USED FOR ANY PURPOSE WITHOUT THE WRITTEN CONSENT OF PALCO.