

**PRODUCTION  
RELEASE**

NOTE:  
THIS DRAWING INCORPORATES  
THIS ANGLE PROJECTION  
INTERPRET SAW ANET 1545-1982

REVISIONS		APPROVED
REV	DESCRIPTION	
B	CHNGT O.C SIZE - ADDED MM & FF NEWS	10/13/10 T. KUHN

**ELECTRICAL**  
 FREQUENCY RANGE \_\_\_\_\_ 10 MHz - 18 GHz  
 INSERTION LOSS \_\_\_\_\_ 0.6 dB MAX  
 VSWR \_\_\_\_\_ 1.35:1 MAX  
 VOLTAGE RATING \_\_\_\_\_ 200 VOLTS  
 IMPEDANCE \_\_\_\_\_ 50 OHMS  
 OPERATING TEMP RANGE \_\_\_\_\_ -65°C TO +125°C

**MECHANICAL**  
 SMA CONNECTORS \_\_\_\_\_ PASSIVATED STAINLESS STEEL  
 CONDUCTORS \_\_\_\_\_ GOLD PLATED BERYLLIUM COPPER  
 HOUSING \_\_\_\_\_ HIGH TEMP PLASTIC

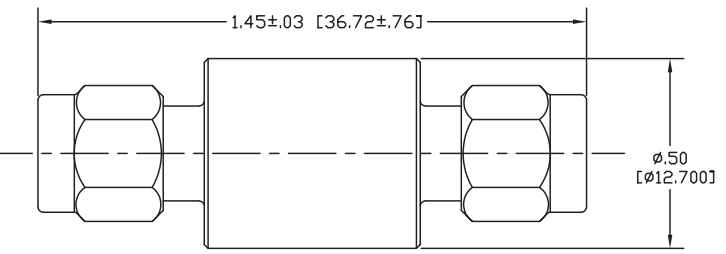

**ORDERING INFORMATION**

P/N	INPUT	OUTPUT	LENGTH
2044-7002-18	MALE	FEMALE	1.30 ± 0.30
2044-7002-18-FF	FEMALE	FEMALE	1.15 ± 0.30
2044-7002-18-MM	MALE	MALE	1.45 ± 0.30

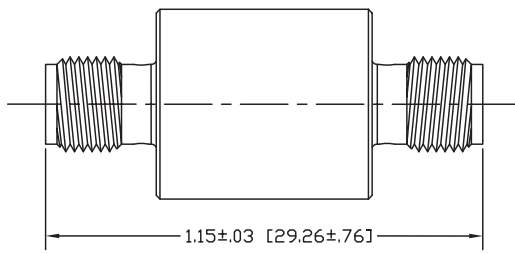
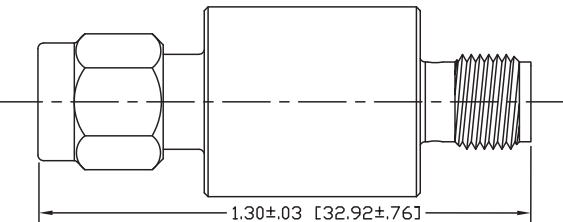

DRAWING PRACTICES FOR ANET-1545 REV. 01-20-05 1:100		UNLESS OTHERWISE SPECIFIED TOLERANCES IN		DRAWN	
DIMENSIONS ARE IN INCHES AND APPLY BEFORE/AFTER PROCESSING		DECIMALS		DATE	
SURFACE FINISHNESS		INCH		T. KUHN 6/22/09	
FRESH SEE NOTES		.XX" .03" [.76]		CHECKED	
MATERIAL SEE NOTES		.XXX" .010" [.25]		DATE	
		.XXXX" .005" [.127]		T. KUHN 6/22/09	
		ANGLES ±0°30'		ENG.	
		REMOVE ALL BURRS/SHARP W/ BREAK .15 OF .001 TO .0005"		T. KUHN	
		UNLESS OTHERWISE NOTED, DIA'S CONCENTRIC +.003 T.I.R.		TITLE	

WWW.XMACorp.com Sales@XMACorp.com

**XMA** Owned by: **Omni Spectra®**

XMA Corp. 150 Dew Bl. Manchester, NH 03045 (603) 222-2256 fax 222-2259

DC BLOCK, SMA, INNER-OUTER  
10MHz-18GHz, 200V

SIZE C CASE CODE 3HT76 DWG NO. 2044-7002-18  
SCALE 5:1 PLATING AREA XXX SHEET 1 OF 1