

5

4

3

2

1

ELECTRICAL

Freq. Range 1.50 GHz - 4 GHz

VSWR 1.5-4 GHz <1.30:1 Max

Insertion Loss 1.5-4 GHz <0.40 dB

Voltage 200 VDC

Power, Peak or Avg. <10 Watts CW

RF Leakage -20 dBC
When measured with dipole antenna for 1/4 wave of frequency and held 1/16" parallel to unit

Operating Temp. Range -55 to +85 °C

DC Resistance between any point on opposite sides of a capacitor or connector Dielectric shall be 20 Meg Ohms minimum.

Impedance - designed for 50 ohm systems.

MECHANICAL

Connectors Outer Passivated Stainless Steel IAW ASTM-A582, Alloy 303, cond. A
Center Conductor Gold Plated (ASTM-B488/MIL-PRF-39012) BeCu IAW ALLOY C17200 OR C17300 IAW ASTM B196
Connector Dielectric Teflon IAW ASTM-D1710

Capacitors Ceramic Substrate with Thick Film Dielectric between metalized plates.

Conformance Testing IAW SSS2044-4014-00 which delineates testing per 11746645 Rev. G paragraph 4.2 B and Table II. signed copy must accompany shipments along with Certificate of Compliance stating information listed in SSS and in SCD Paragraph 5.1.1 and both signed.
REF. BENDIX 11746645

PRODUCTION RELEASE

NOTE:
THIS DRAWING INCORPORATES THIRD ANGLE PROJECTION.
INTERPRET IAW ANSI Y14.5-1992

REVISIONS

LTR	DESCRIPTION	DATE	APPROVED
G1	TYPO - CHANGED P/N	7/30/09	T. KUHN

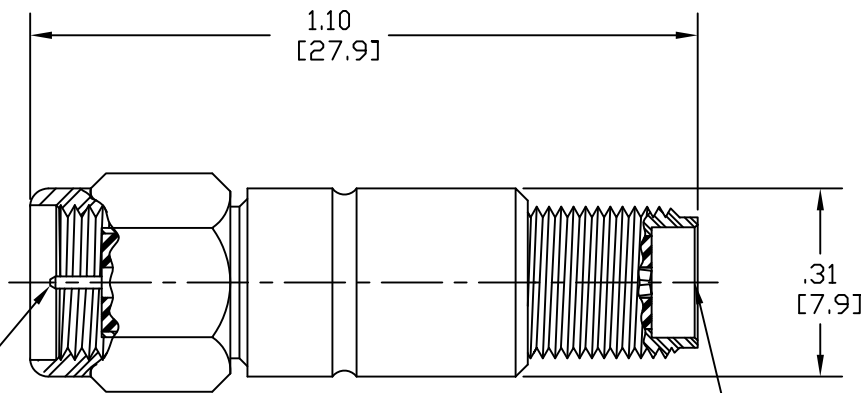

SMA MALE (OUTPUT) IAW MIL-PRF-39012 AND MIL-STD-348

SMA FEMALE (INPUT) IAW MIL-PRF-39012 AND MIL-STD-348

DRAWING PRACTICES PER ANSI-Y-14.5 MIL-STD-100 & 1000	
DIMENSIONS ARE IN INCHES AND APPLY BEFORE/AFTER PROCESSING	
SURFACE ROUGHNESS	63 ✓
FINISH	SEE NOTES
MATERIAL	SEE NOTES

UNLESS OTHERWISE SPECIFIED TOLERANCES IN:	
DECIMALS	INCH MM
.X"	.030" [.76]
.XX"	.015 [.37]
.XXX"	
.XXXX"	ANGLES
UNLESS OTHERWISE NOTED DIAS CONCENTRIC <.003 T.I.R.	

DRAWN	D. SAUNDERS	DATE	
CHECKED		DATE	
ENG.		DATE	
THESE DRAWINGS AND SPECIFICATIONS ARE THE PROPERTY OF XMA CORP. OR OMNI SPECTRA AND SHALL NOT BE REPRODUCED, COPIED NOR USED - IN WHOLE OR IN PART - AS A BASIS FOR THE MANUFACTURE OR SALE OF OTHER ITEMS WITHOUT THE EXPRESS WRITTEN PERMISSION OF XMA CORP.			

NO.

Omni Spectra Corporation
Microwave Components
150 Dow Street, Manchester, NH 03101
P: 603-222-2256
F: 603-222-2259

TITLE
**INNER AND OUTSIDE DC BLOCK
SMA, CUSTOM DESIGN**

SIZE	CAGE CODE	DRAWING NUMBER
B	3HT76	2044-4014-00
SCALE	PLATED AREA	SHEET 1 OF 1
5:1	XXX	

BCSI

5

4

3

2

1

D

C

B

A

D

C

B

A