

REV.	DATE	DESCRIPTION
A	04/31/03	UPDATE DRAWING FORMAT

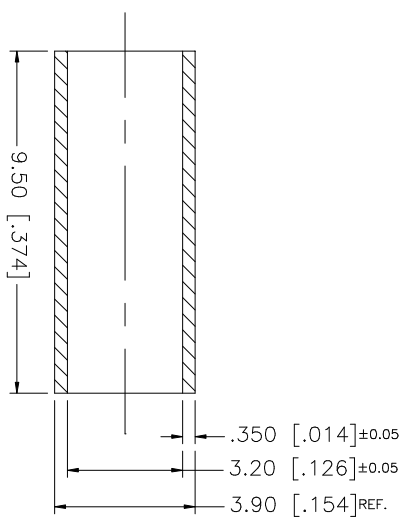

REMARK:
 ROCKWELL HARDNESS OF
 55 MAX. ON 15-T SCALE
 (HEAT TREAT FOR 45 MIN.
 AT 1100°F BEFORE PLATING)

QTY	FINISH	MATERIAL	DESCRIPTION
1	GOLD	BRASS	FERRULE

UNLESS OTHERWISE SPECIFIED DIMENSIONS ARE IN INCHES AND FOR CUSTOMER REFERENCE ONLY.	UNLESS OTHERWISE SPECIFIED DIMENSIONS ARE IN MILLIMETERS
0.5 - 8mm ± 0.20mm	0.5 - 8mm ± 0.20mm
8 - 30mm ± 0.40mm	8 - 30mm ± 0.40mm
30 - 120mm ± 0.50mm	30 - 120mm ± 0.50mm

UNLESS OTHERWISE SPECIFIED DIMENSIONS ARE IN INCHES	UNLESS OTHERWISE SPECIFIED DIMENSIONS ARE IN MILLIMETERS
.020 - .315 = ± 0.007"	.020 - .315 = ± 0.007"
.315 - 1.180 = ± 0.015"	.315 - 1.180 = ± 0.015"
1.180 - 4.724 = ± 0.020"	1.180 - 4.724 = ± 0.020"

APPROVALS	DATE
DRAWN G.R.S.	04/31/03
CHECKED	
ISSUED	
SHEET 1 OF 1	

CAD FILE	DWG. NO.	REV.	SIZE	SCALE
C:/MISC/FRL-SMA-316.DWG	FRL-SMA-316.DWG	A	A	NA

PART DESCRIPTION	PART NO.
Amphenol Connex	FRL-SMA-316
FERRULE-SMA-316	