

REV.	DESCRIPTION	DATE	BY
C	SEE ECO GM-10819	12/17/99	CGA

MATERIAL AND FINISH

PLUG HOUSING AND COUPLING NUT: CRES 303 PER ASTM A 484 AND ASTM A 582 OR ASTM A 555 AND ASTM A 581. PASSIVATE PER MIL-F-14072 E300.

CENTER CONTACT AND OUTER CONDUCTOR: BERYLLIUM COPPER PER ASTM B 196 AND/OR ASTM B 197. GOLD PLATE PER MIL-G-45204; TYPE 1, GRADE C, CLASS 1. OVER NICKEL PER QQ-N-290A; CLASS 1; 50 MICRONS MIN.

DIELECTRICS: VIRGIN PTFE FLUOROCARBON PER ASTM D 1710 AND ASTM D 1457.

RETAINING RING: BERYLLIUM COPPER PER ASTM B 196 AND/OR ASTM B 197.

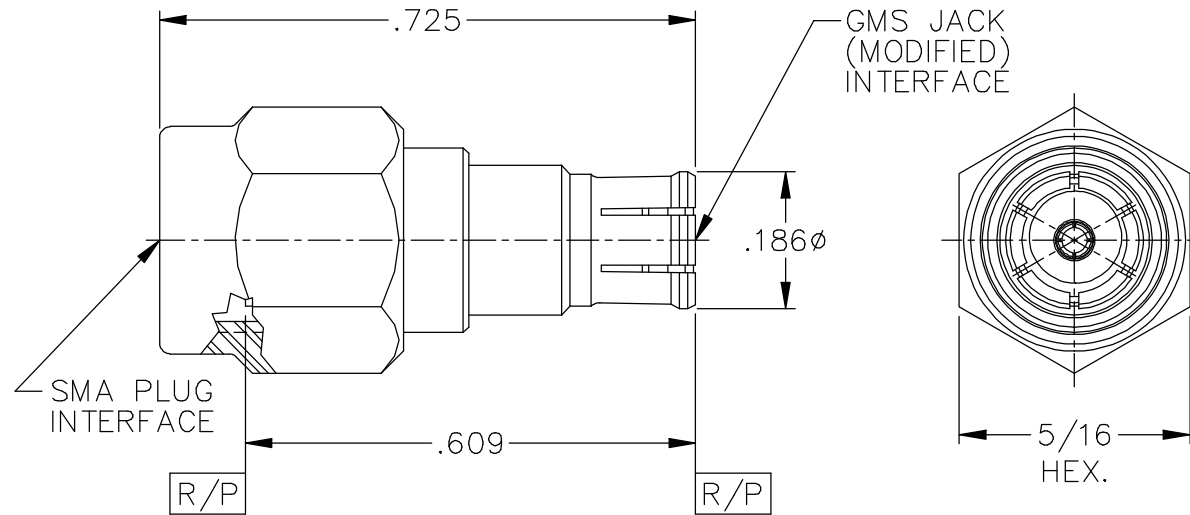

This drawing and any data contained therein is the property of Gilbert Engineering Co. Inc., and constitutes and contains proprietary and confidential information. Neither receipt nor possession of this drawing confers or transfers any right to duplicate, use or disclose any information contained herein except as expressly authorized by Gilbert Engineering Co. Inc.	ALL DIMENSIONS IN INCHES		CATALOG NUMBER 00218-201-3	CODE IDENT NO. 82316
	DRAWN:	GILBERT ENGINEERING CO., INC.		
	DES	TITLE	OUTLINE DRAWING FOR SMA PLUG TO GMS (MODIFIED) JACK 38999 ADAPTOR	
	DATE	1/21/92	DWG. NO.	OL-00218-201-3
	ASSEMBLY PROCEDURES: NONE		REV C	
SOURCE FILE: MECR# 622	SHT. 1	OF 1		