

DATE REVISED: 12/9/03

CATALOG NUMBER
1F2H1-0501-01

MATERIAL AND FINISH

HOUSING AND COUPLING NUT: CRES 303; PASSIVATED
 CENTER CONTACT AND INNER HOUSING: BeCu; GOLD PLATE 50-100 MICRONS OVER NICKEL PLATE 50 MICRONS MIN.
 RETAINING RING: BeCu
 DIELECTRICS: VIRGIN PTFE (TEFLON)

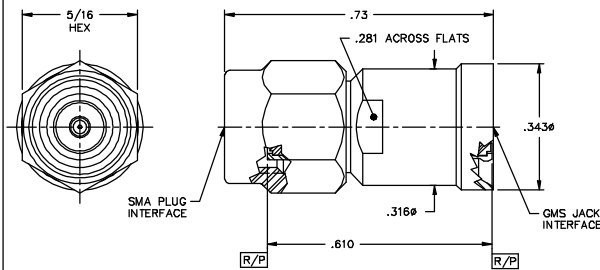
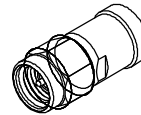

This drawing and any data contained herein is the property of Corning Gilbert Inc., and constitutes and contains proprietary and confidential information. Neither receipt nor possession of this drawing confers or transfers any right to duplicate, use or disclose any information contained herein except as expressly authorized by Corning Gilbert Inc.

SMA PLUG TO GMS JACK ADAPTER	IDENT CODE: 82316	Corning Gilbert Inc.
	REVISION: A	
SOURCE FILE: MECR# 2457	DWG. NO.: OL-1F2H1-0501-01	ASSY. PROC.: -