

This drawing and any data contained therein is the property of Gilbert Engineering Co., Inc. and constitutes and contains proprietary and confidential information. Neither receipt nor possession of this drawing confers or transfers any right to duplicate, use, or disclose any information contained herein except as expressly authorized by Gilbert Engineering Co. Inc.

REV.	DESCRIPTION	DATE	APP'D.
06	REVISED	6-30-97	

### MATERIAL AND FINISH

HOUSING, NUT, AND BUSHING: CRES 303 PER ASTM A 484 AND ASTM A 582 OR ASTM A 555 AND ASTM A 581. PASSIVATE PER MIL-F-14072 E 300.

PIN CONTACT: BERYLLIUM COPPER PER ASTM B196 AND/OR ASTM B197. GOLD PLATE PER MIL-G-45204; TYPE I, GRADE C, CLASS 1.

DIELECTRICS: VIRGIN PTFE FLUOROCARBON PER ASTM D 1710 AND ASTM D 1457.

WASHER: 400 STAINLESS STEEL

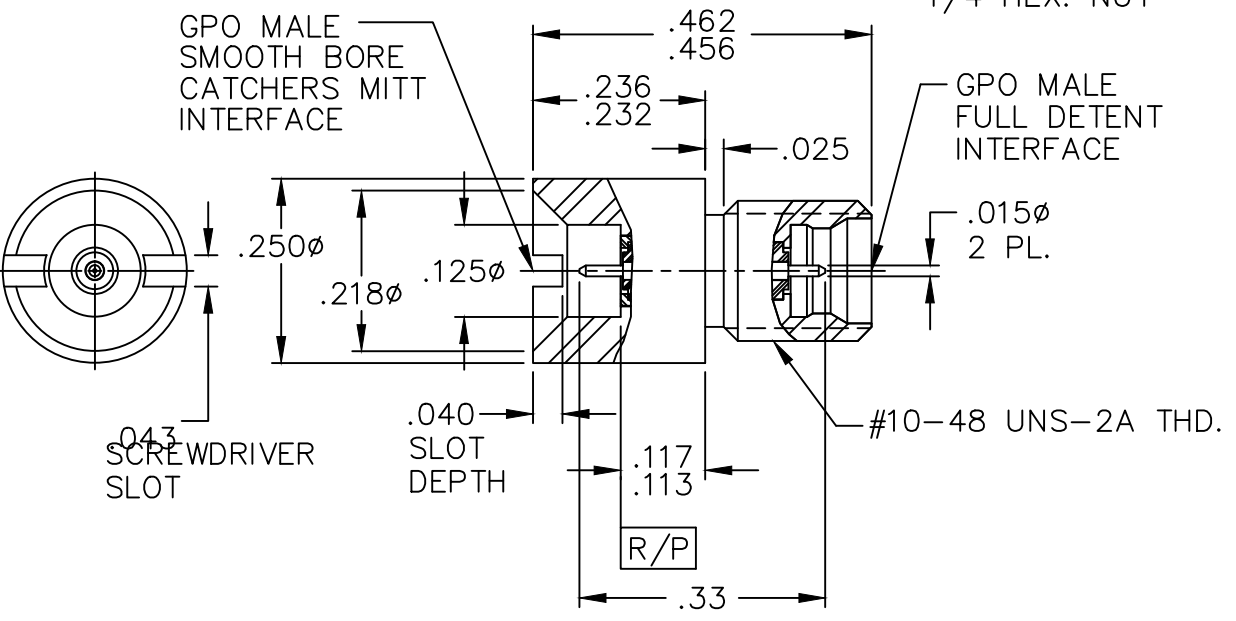
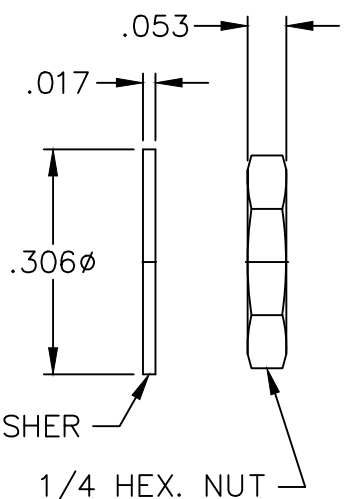

ALL DIMENSIONS ARE IN INCHES

CAT. NO. 0119-499-3

CODE IDENT NO. 82316

GILBERT ENGINEERING CO., INC.

BY	DATE	TITLE
DRAWN: PAC	12/18/96	OUTLINE DRAWING FOR GPO MALE FULL DETENT TO GPO MALE SMOOTH BORE CATCHERS MITT WITH HARDWARE
ASSEMBLY PROCEDURES: NONE		
SOURCE FILE: SK-1194	SHT. 1 OF 1	DWG. NO. OL-SK-1194
		REV 06