

This drawing and any data contained therein is the property of Gilbert Engineering Co., Inc., and constitutes and contains proprietary and confidential information. Neither receipt nor possession of this drawing confers or transfers any right to duplicate, use, or disclose any information contained herein except as expressly authorized by Gilbert Engineering Co. Inc.

DWG. NO. SS-7125-5

PART REV. B

### MATERIAL & FINISH

HOUSING: CRES 303 PER ASTM A484  
PASSIVATE PER MIL-F-14072 E 300.

CENTER CONTACT: BERYLLIUM COPPER PER ASTM B196 OR ASTM B197 GOLD PLATE PER MIL-G-45204.

DIELECTRIC: TFE FLUOROCARBON PER MIL-P-19468A & FED SPEC L-P-403.

O-RING: RUBBER, FLUOROCARBON ELASTOMER PER AMS-3304 & FED SPEC ZZ-R-765.

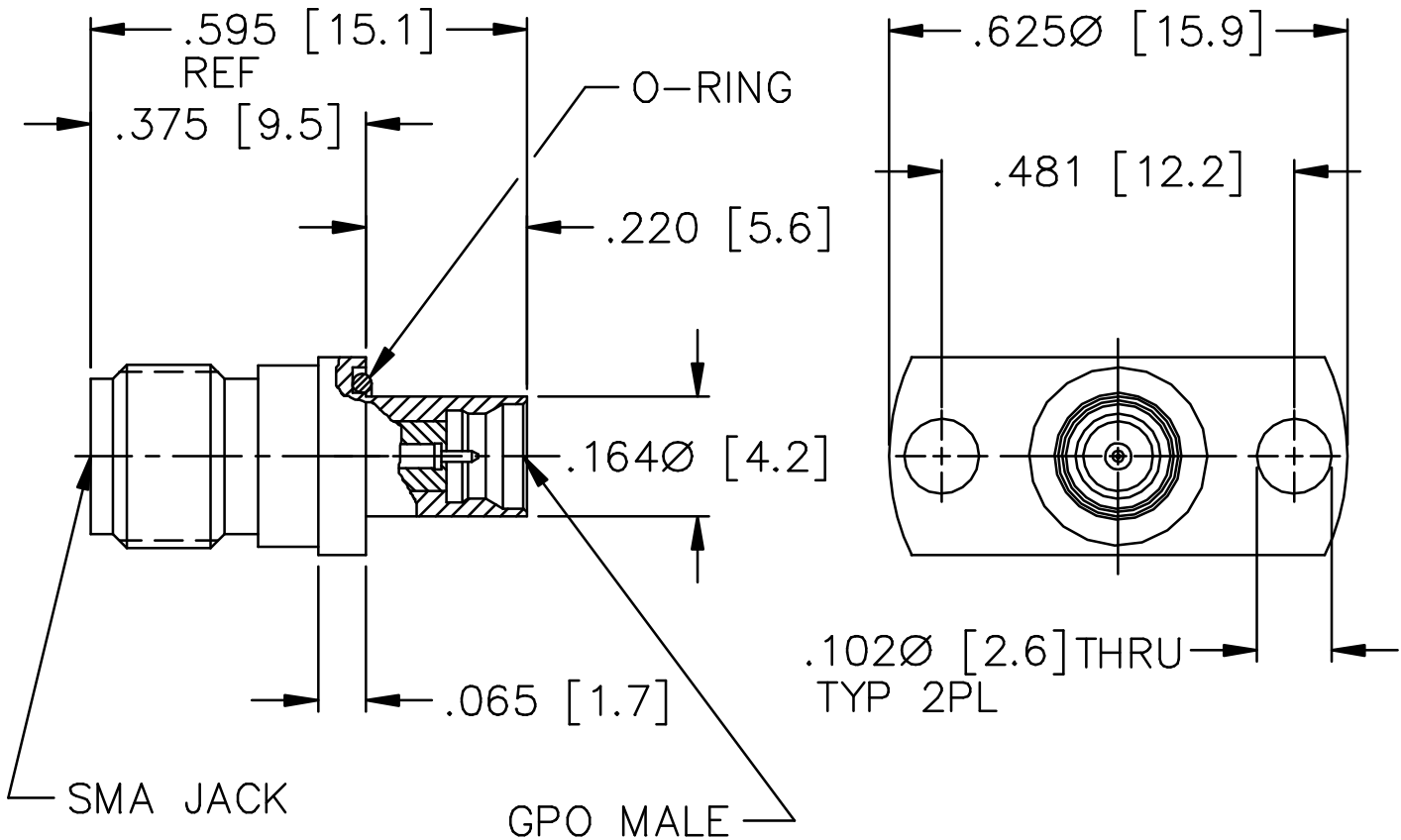

ALL DIMENSIONS ARE IN INCHES AND [MILLIMETERS]

CAT. NO. 00219-125-3

CODE IDENT NO. 82316

GILBERT ENGINEERING CO., INC.

BY		DATE	
DRAWN REL		7/6/93	
CHECKED			
SHT.	1	OF	1

TITLE	
SMA JACK 2 HOLE FLANGE MOUNT TO GPO MALE ADAPTOR	
DWG. NO.	SS-7125-5
REV	B

4=1