

CATALOG NUMBER
00219-116-3

MATERIAL AND FINISH

HOUSING: CRES 303; PASSIVATED
 CENTER CONTACT: BeCu; GOLD PLATE 50-100 MICRONS OVER NICKEL PLATE 50 MICRONS MIN.
 DIELECTRICS: VIRGIN PTFE
 O-RING: SILICONE RUBBER

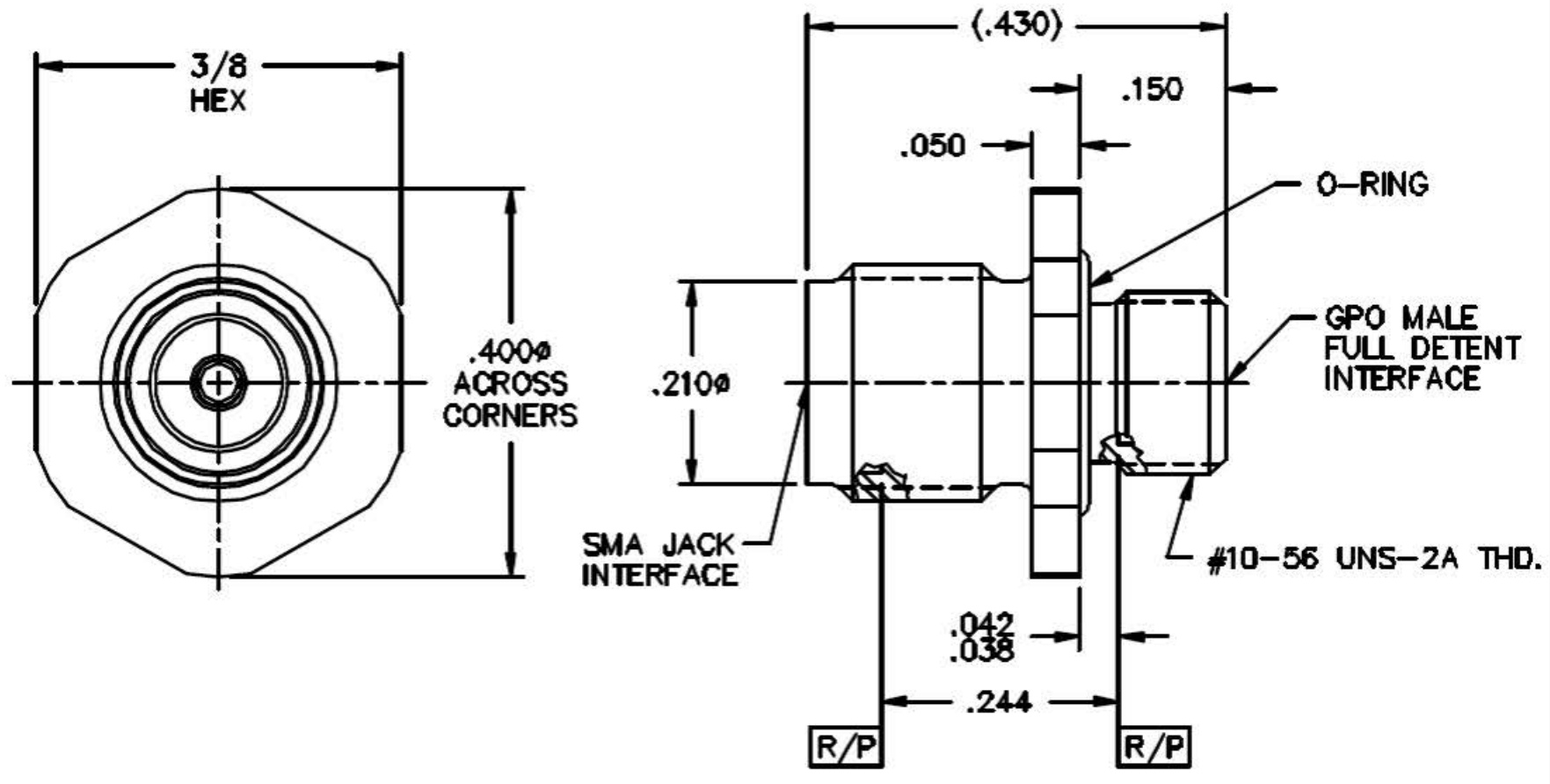
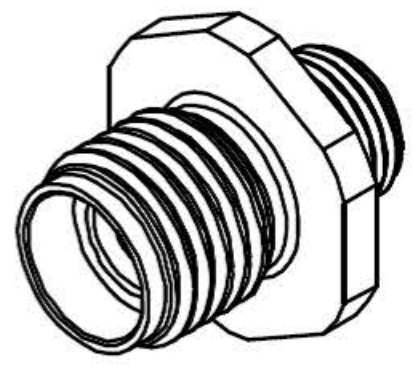

This drawing and any data contained herein is the property of Corning Gilbert Inc., and constitutes and contains proprietary and confidential information. Neither receipt nor possession of this drawing confers or transfers any right to duplicate, use or disclose any information contained herein except as expressly authorized by Corning Gilbert Inc.

GPO MALE FULL DETENT
TO SMA JACK
THREAD-IN ADAPTER

IDENT CODE:
82316
REVISION: C

Corning Gilbert Inc.

SOURCE FILE: MECR# 953 | DWG. NO.: 0L-00219-116-3 | ASSY. PROC.: -