

DATE REISED: 11/1/04

CATALOG NUMBER	"A" INTERFACE
1A3F1-0513-03	FULL DETENT
1A4F1-0513-03	LIMITED DETENT
1A5F1-0513-03	SMOOTH BORE

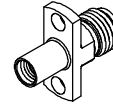

MATERIAL AND FINISH

HOUSING: CRES 303; PASSIVATED
 CENTER CONTACT: BeCu; GOLD PLATE 50-100 MICRONS
 OVER NICKEL PLATE 50 MICRONS MIN.
 DIELECTRICS: VIRGIN PTFE

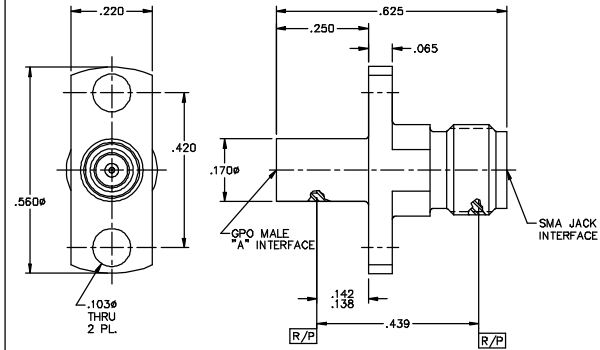

This drawing and any data contained herein is the property of Corning Gilbert Inc., and constitutes and contains proprietary and confidential information. Neither receipt nor possession of this drawing confers or transfers any right to duplicate, use or disclose any information contained herein except as expressly authorized by Corning Gilbert Inc.

GPO MALE 2 HOLE FLANGE MOUNT TO SMA JACK ADAPTER		IDENT CODE: 82316	Corning Gilbert Inc.
		REVISION: F	
SOURCE FILE: MECR# 2059	DWG. NO.: OL-1AXF1-0513-03	ASSY. PROC.: -	