

CATALOG NUMBER	"A" INTERFACE
----------------	---------------

00215-210-1-FD	FULL DETENT
----------------	-------------

00215-210-1-SB	SMOOTH BORE
----------------	-------------

MATERIAL AND FINISH

GPPO HOUSING AND
COUPLING NUT:

CRES 303; PASSIVATED

PLUG HOUSING AND
CENTER CONTACT:BeCu; GOLD PLATE 50-100 μ INCHES
OVER NICKEL PLATE 50 μ INCHES MIN.

RETAINING RING:

BeCu

DIELECTRICS:

VIRGIN PTFE (TEFLON)

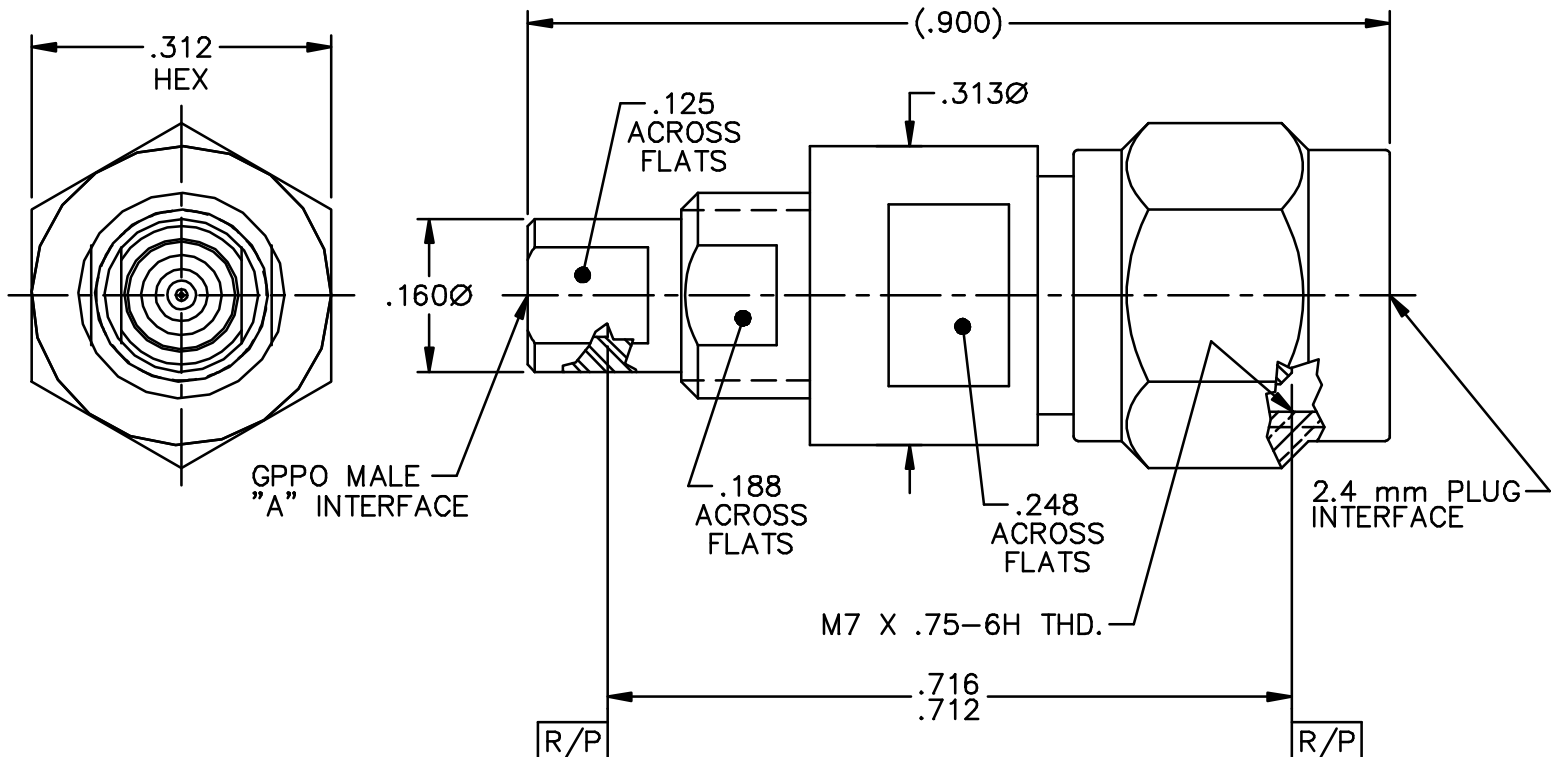
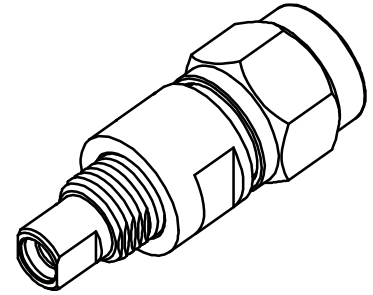

GPPO MALE TO
2.4 mm PLUG ADAPTOR
(TAB DETENT)

IDENT CODE:
82316

REVISION: D

**GILBERT
ENGINEERING**

SOURCE FILE: SK-1931

DWG. NO.: OL-00215-210-1-TAB

ASSY. PROC.: -