

- 1.0 PERFORMANCE: (sea level)
- 1.1 FREQUENCY: DC-18 GHz
- 1.2 VSWR TYPICAL: (1.05, 3 GHz), (1.12, 11 GHz), (1.30, 18 GHz)
- 1.3 NOMINAL IMPEDANCE: 50 OHM
- 1.4 VOLTAGE RATING: 12 Vrms
- 1.5 DWV: 500 Vrms @ 60 Hz
- 1.6 TEMPERATURE RANGE: -65/+165°C

- 2.0 MATERIALS: RoHS COMPLIANT
- 2.1 DIELECTRIC: PTFE
- 2.2 CONTACT: BeCu, Au/Ni
- 2.3 N BODY: SS-303, PASSIVATE
- 2.4 SMP BODY: BeCu, Au/Ni
- 3.0 FINISH: SEE TABLE

- 4.0 MECHANICAL
- 4.1 INTERFACES PER MIL-STD-348
- 4.2 CONTACT RETENTION:
6 LBS MIN AXIAL
TORQUE: N/A

DWG NO. 0910-99-1		REV. A
PART NUMBER	BODY	CONTACT
0910-99-PJ	PASSIVATE	GOLD

PLATING PER SAN-TRON SPEC. 7.3.1-8

DO NOT SCALE DRAWING

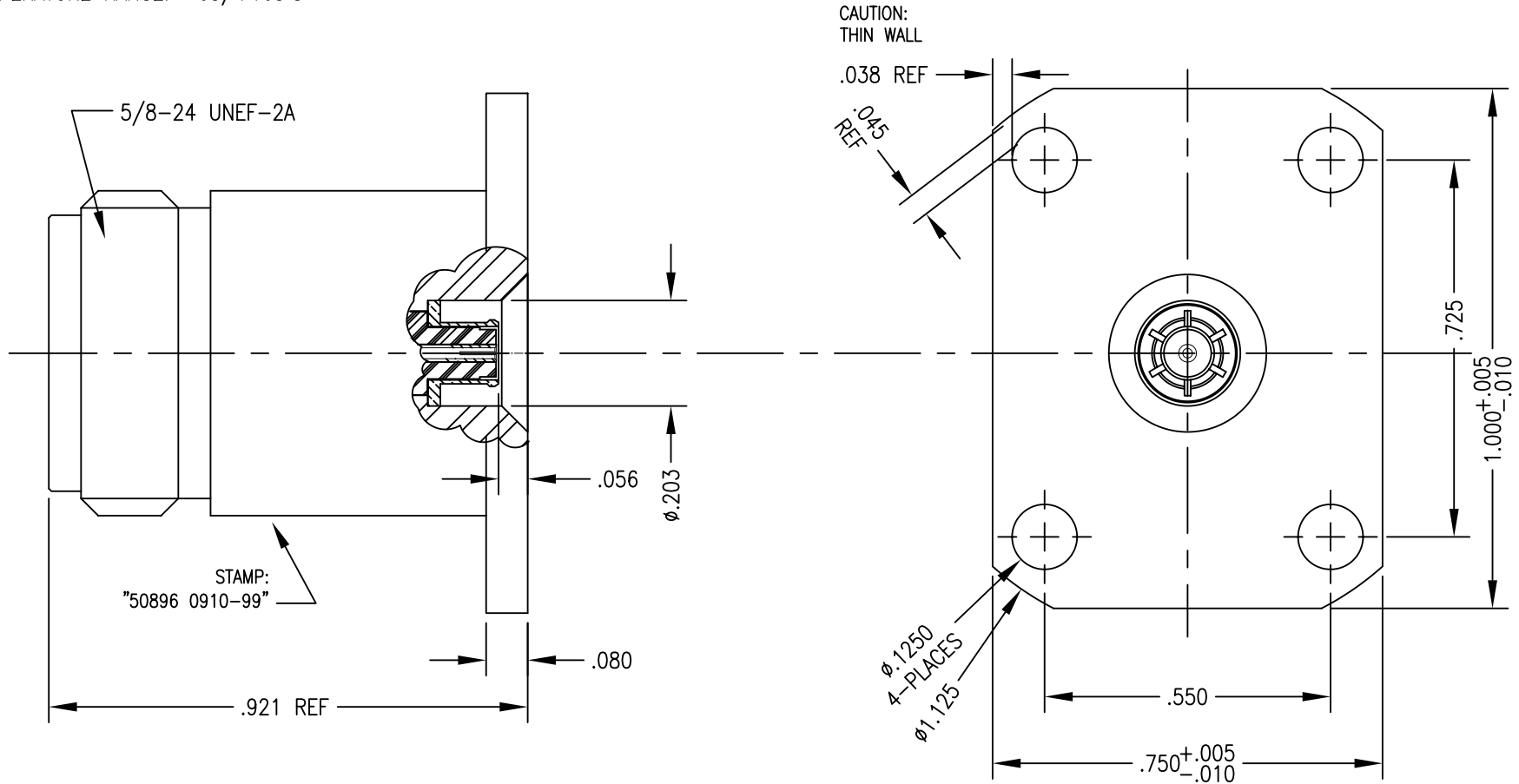

Rev.	Revisions	Disp.	Date	Dwn.	Appd.
A	RELEASE TO PRODUCTION		4/15/08	FSH	FSH
4	PRELIMINARY: PROTOTYPE MFG (change body -6 --> -5)		4/11/08		

Ref.: SK-	REMOVE ALL BURRS AND SHARP EDGES .005 MAX.	INTERPRET PER ASME Y14.5M-1994
--------------	--	--------------------------------

THIS DRAWING CONTAINS CONFIDENTIAL INFORMATION PROPRIETARY TO SAN-TRON, INC. IT MUST NOT BE REPRODUCED OR DISCLOSED TO OTHERS OR USED IN ANY OTHER WAY, IN WHOLE OR PART EXCEPT AS AUTHORIZED IN WRITING BY SAN-TRON, INC.

UNLESS OTHERWISE SPECIFIED:
ALL DIMENSIONS ARE IN INCHES.
ALL DIMENSIONS ARE AFTER PLATING.
.XXX = ±.005 ALL MACHINED SURFACES $\frac{64}{\sqrt{\text{MAX.}}}$
.XX = ±.01 ANG. ±1/2° FRACTIONAL = ±1/64
Ⓢ.004 MAX. TIR ⊥ AXIS .001

THIRD ANGLE PROJECTION

DWN	FSH	4/1/08
CHKD	SJS	4/14/08
APPR	FSH	4/11/08

SAN-TRON, INC.
 4 NEWBURYPORT TPK. IPSWICH MA USA 01938
 TEL: 978-356-1585 FAX: 978-356-1573
 WWW.SANTRON.COM E MAIL: santron@santron.com

**TITLE ADAPTER, N (F) - SMP (P)
 STRAIGHT, PANEL MOUNT, 1.00X.75**

MATERIAL: FINISH: SEE TABLE - ALLOW FOR .0002/.0004 PLATING

CAGE CODE: 50896 DWG NO. 0910-99-1 REV. A
 SCALE X:X