

CONTROL DRAWING

29065-4

Q

NOTES:

1. DESCRIPTION,
ADAPTOR, N PLUG TO SMA JACK, 90° SWEEP.
2. MATERIALS AND FINISHES,
BODY AND NUT,
STEEL, CORROSION RESISTANT PER ASTM A-582,
UNS No. S30300, COND. A, NON MAGNETIC,
PASSIVATED PER SAE-AMS-2700.
NO DICHROMATE SOLUTIONS USED.
SWEEP BODY,
SILICON BRONZE CASTING PER ASTM B-584 UNS No. C87600,
NICKEL PLATED 100 µIN (2.54 µM) MIN. THK.
PER SAE-AMS-C-26074 OR ASTM B-733.
CENTER CONDUCTOR,
BERYLLIUM COPPER ALLOY PER ASTM B-196,
UNS No. C17300, TEMPER TD04(H),
GOLD PLATED 50 µIN (1.27 µM) MIN. THK.
PER ASTM B-488, CODE C, TYPE II, CLASS 1.27
OVER
NICKEL PLATE, 50 µIN (1.27 µM) MIN. THK.
PER SAE-AMS-QQ-N-290, CLASS 1.
DIELECTRIC,
POLYTETRAFLUOROETHYLENE (PTFE) PER ASTM D-1710,
OR ASTM D-4894, TYPE I, GRADE 1, CLASS A.
RETAINING RING,
CORROSION RESISTANT SPRING STEEL WIRE, COLD DRAWN,
PER ASTM A-313, UNS No. S30200,
PASSIVATED PER SAE-AMS-2700.
NO DICHROMATE SOLUTIONS USED.
GASKET,
SILICONE RUBBER PER GSA CID A-A-59588-2B
AND SAE-AMS-3304.
3. ELECTRICAL CHARACTERISTICS:
IMPEDANCE
50.0 Ohms NOMINAL.
FREQUENCY
18.0 GHz MAX.
INSERTION LOSS
0.40 dB MAX.
VSWR
1.25 : 1 MAX.
4. INTERFACE MEETS MIL-STD-348.
5. OPERATING TEMPERATURE RANGE
-55° C TO +125° C

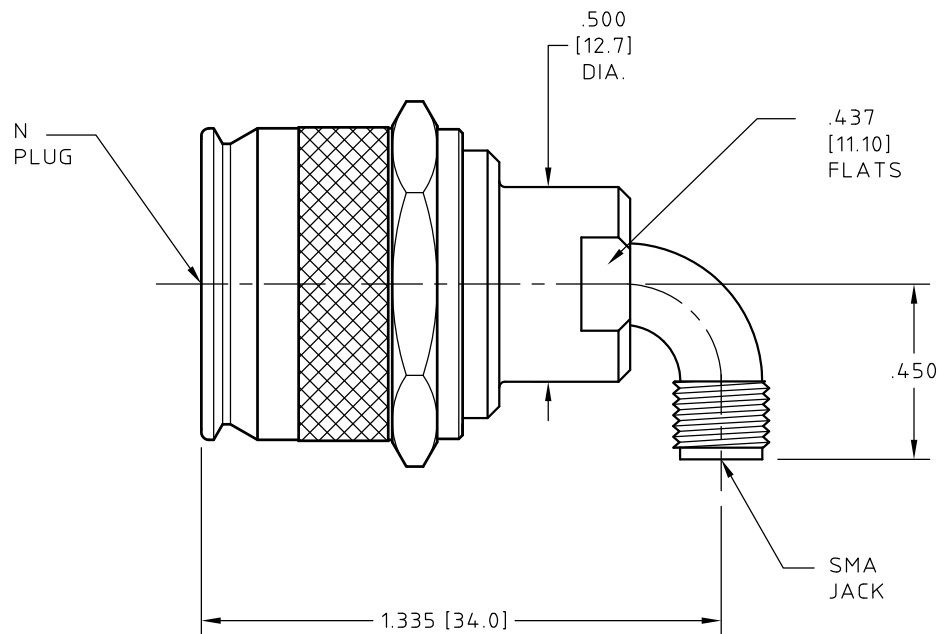

RoHS 6 COMPLIANT

NAME	DATE	<p style="font-size: small; margin-top: 10px;">THIS DRAWING CONTAINS PATENTABLE AND PROPRIETARY INFORMATION. THE DESIGN CANNOT BE USED WITHOUT WRITTEN PERMISSION OF HUBER + SUHNER ASTROLAB.</p>
PREP.		
ELEC.		
MECH.		
Q.C.		
TITLE		

ADAPTOR, N PLUG TO SMA JACK, 90° SWEEP

Q	ADDED RoHS 6 DEFINITION	02/07/17	EB																										
REV.	DESCRIPTION	DATE	BY	APPROVED	<table border="1" style="font-size: x-small; border-collapse: collapse;"> <tr> <td>FRACTIONS</td> <td>± 1/16</td> </tr> <tr> <td>X</td> <td>± .030</td> </tr> <tr> <td>XX</td> <td>± .015</td> </tr> <tr> <td>XXX</td> <td>± .005</td> </tr> <tr> <td>ANGLES</td> <td>± 1°</td> </tr> <tr> <td colspan="2">DO NOT SCALE DRAWING</td> </tr> </table>		FRACTIONS	± 1/16	X	± .030	XX	± .015	XXX	± .005	ANGLES	± 1°	DO NOT SCALE DRAWING		<table border="1" style="font-size: x-small; border-collapse: collapse;"> <tr> <td>THDS. TO BE IN ACCORD WITH U.S. DEPT. OF COMM. SCREW THD. STDS. FOR FEDERAL SERVICES 1950 SUPL. TO HANDBOOK H 28.</td> <td>SCALE</td> <td>CODE IDENT.</td> <td>DWG NO.</td> <td>REV</td> </tr> <tr> <td></td> <td>2:1</td> <td>16301</td> <td>29065-4</td> <td>Q</td> </tr> </table>	THDS. TO BE IN ACCORD WITH U.S. DEPT. OF COMM. SCREW THD. STDS. FOR FEDERAL SERVICES 1950 SUPL. TO HANDBOOK H 28.	SCALE	CODE IDENT.	DWG NO.	REV		2:1	16301	29065-4	Q
FRACTIONS	± 1/16																												
X	± .030																												
XX	± .015																												
XXX	± .005																												
ANGLES	± 1°																												
DO NOT SCALE DRAWING																													
THDS. TO BE IN ACCORD WITH U.S. DEPT. OF COMM. SCREW THD. STDS. FOR FEDERAL SERVICES 1950 SUPL. TO HANDBOOK H 28.	SCALE	CODE IDENT.	DWG NO.	REV																									
	2:1	16301	29065-4	Q																									