

NOTES:

1. INTERFACE DIMENSIONS ARE IN ACCORDANCE WITH MIL-STD-348 .
2. ALL DIMENSIONS ARE REFERENCE ONLY .

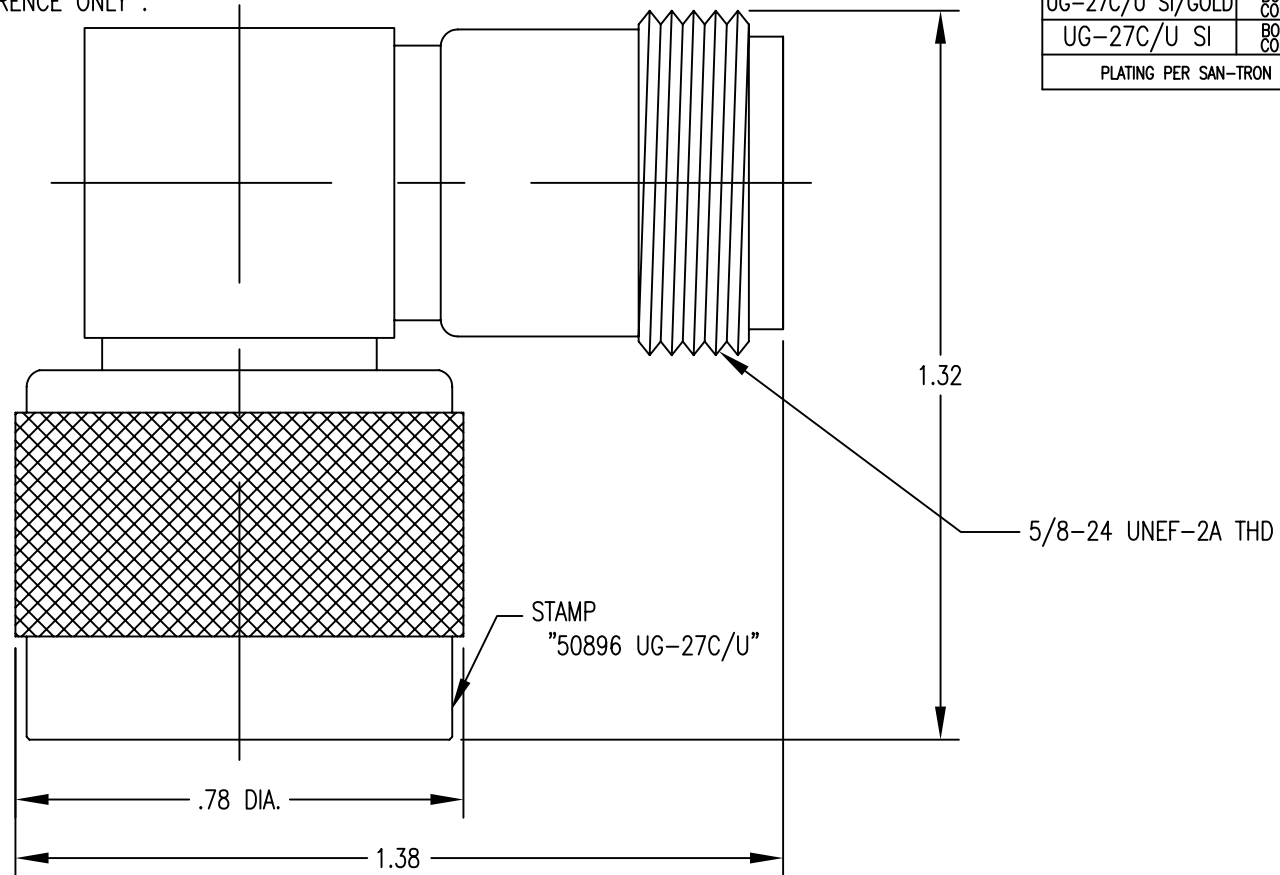

DWG NO. OL-27C-1		REV. A
PART NUMBER	PLATING	
UG-27C/U	BODY: NICKEL CONTACT: SILVER	
UG-27C/U SI/GOLD	BODY: SILVER CONTACT: GOLD	
UG-27C/U SI	BODY: SILVER CONTACT: SILVER	
PLATING PER SAN-TRON SPEC. 7.3.1-8		

Rev.	Revisions	Date	Dwn.	Appd.
A ₁	ADDED PLATE CHART TO DRAWING	3/10/05	RF	FSH
A	ORIGINAL	1/10/97	X	X
RECOM.	STOCK SIZE	FT/M PCS	QTY REQD	

PROPRIETARY
THIS DRAWING CONTAINS CONFIDENTIAL INFORMATION PROPRIETARY TO SAN*TRON INC. IT MUST NOT BE REPRODUCED OR DISCLOSED TO OTHERS OR USED IN ANY OTHER WAY, IN WHOLE OR PART EXCEPT AS AUTHORIZED IN WRITING BY SAN*TRON INCORPORATED.

REMOVE ALL BURRS AND SHARP EDGES .005 MAX.
UNLESS OTHERWISE STATED ALL DIMENSIONS ARE IN INCHES AND APPLY AFTER PLATING

UNSPECIFIED TOL.	DWN	KC	1/10/97
DEC. ± .005	CHKD	SJS	1/14/97
FRAC. ± 1/64	APPR		
ANG. ± 1/2°			

CONCENTRICITY .004 TIR ⁶³/_✓
ALL MACHINED SUFACES



SAN • TRON, INC.

4 NEWBURYPORT TPK, IPSWICH, MA 01938

TITLE	RIGHT ANGLE ADAPTER N(M)-(F)		
MATERIAL:	FINISH: NICKEL CONTACT: SILVER		
FSCM NO. 50896	DWG NO.	REV.	
SCALE 3:1	OL-27C-1	A	