

***** THIS DRAWING AND ITS CONTENTS ARE THE SOLE PROPERTY OF PRECISION CONNECTOR INC. AND ARE SUBJECT TO CHANGE WITHOUT NOTICE UNLESS OTHERWISE SPECIFIED *****

REV.	DESCRIPTION	DATE	BY	APPVD
A	INITIAL RELEASE	09/12/13	MJK	MJK

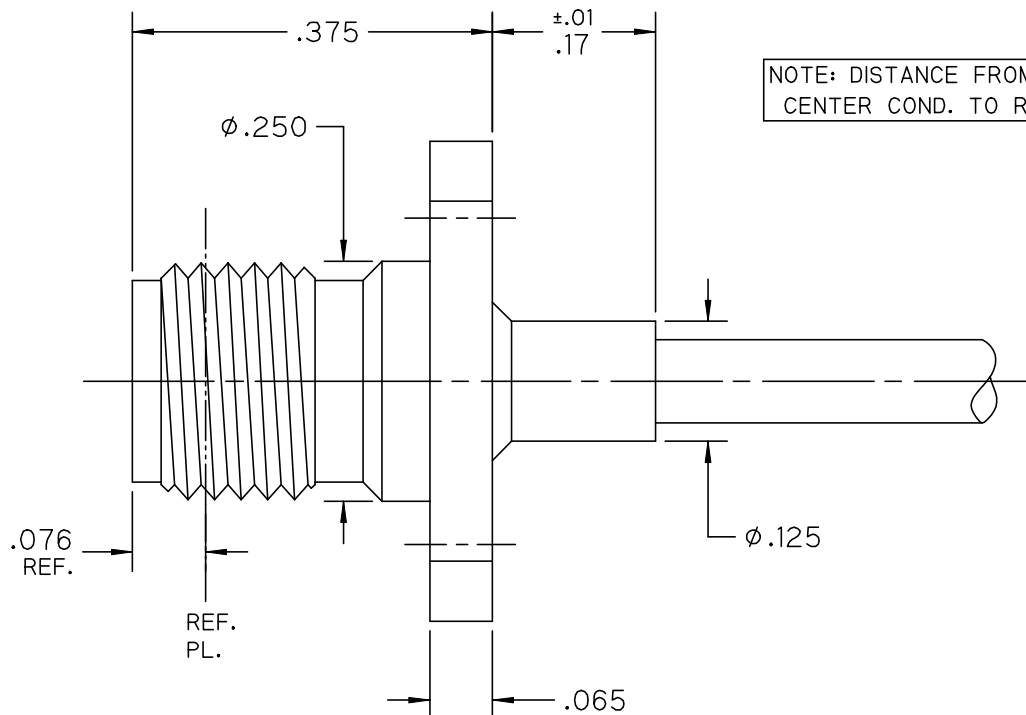

NOTE: DISTANCE FROM END OF CABLE CENTER COND. TO REF. PL. IS .265

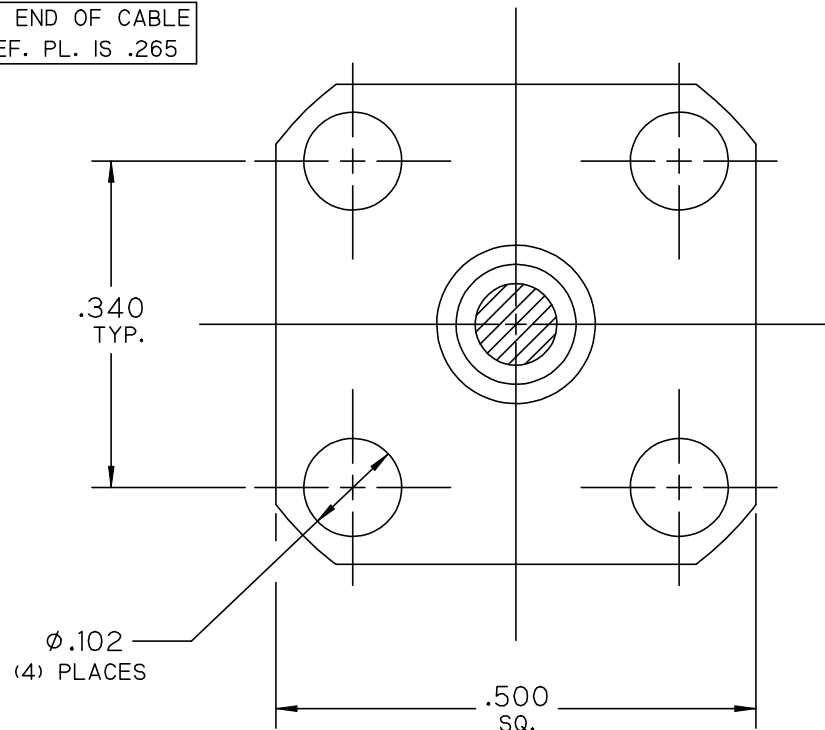

NOTES :

1.0 MATERIALS:

- 1.1 BODY & BUSHING: STEEL, CORROSION RESISTANT PER ASTM-A582, UNS NO. S30300.
- 1.2 CENTER COND.: BERYLLIUM COPPER PER ASTM-B196, UNS C17300.
- 1.3 DIELECTRIC BEAD: POLYETHERIMIDE THERMOPLASTIC (ULTEM 1000) PER ASTM-D5205.

2.0 FINISHES:

- 2.1 CENTER COND.* BODY: GOLD PLATE PER ASTM-B488. 50 MICROINCHES MIN. THK. OVER ELECTROLYTIC NICKEL PLATE PER ASTM-B689 50 MICROINCHES MIN. THK.
- 2.2 BUSHING: PASSIVATE PER SAE-AMS-2700.
- 2.3 DIELECTRIC BEAD: NONE.

3.0 INTERFACE PER PCI-2.92mm-SOC.



TOLERANCES UNLESS OTHERWISE SPECIFIED	DRAWN BY: MJK	DESC.: 2.92mm JACK, 4-HOLE FLANGE MOUNT, DIRECT SOLDER FOR RG-405 CABLE			
	DATE: 09/12/13	SCALE	SHEET NO.	DRAWING NUMBER	REV
.XX ± .02	CAGE CODE	5:1	1 OF 1	3859-0L	A
.XXX ± .005	4MJR5				
.XXXX ± .0005					
ANGLES ± 2°					