

SPECIFICATION CONTROL DRAWING

THIS DRAWING CONTAINS INFORMATION PROPRIETARY TO RF INDUSTRIES, LTD. ANY UNAUTHORIZED USE OF THIS DRAWING IS EXPRESSLY PROHIBITED. ANY VIOLATION IS PUNISHABLE UNDER U.S. COPYRIGHT LAWS.

| REV | DESCRIPTION | DWN | DATE | APPROVED |
|-----|---------------------|-----|---------|----------|
| A | ENGINEERING RELEASE | CZS | 8/25/99 | R. RICE |
| | | | | |
| | | | | |

ALL DIMENSIONS ARE REFERENCE ONLY

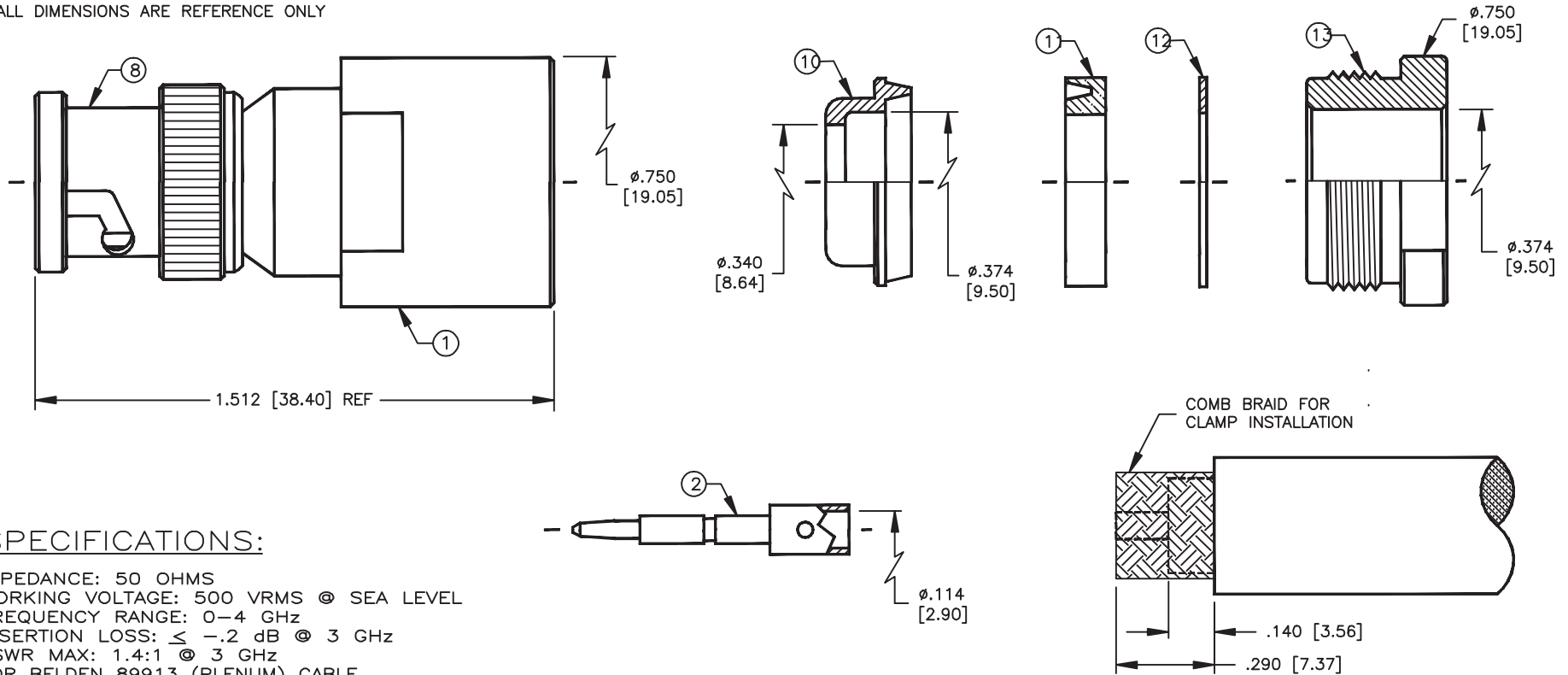

SPECIFICATIONS:

IMPEDANCE: 50 OHMS
 WORKING VOLTAGE: 500 VRMS @ SEA LEVEL
 FREQUENCY RANGE: 0-4 GHz
 INSERTION LOSS: ≤ -2 dB @ 3 GHz
 VSWR MAX: 1.4:1 @ 3 GHz
 FOR BELDEN 89913 (PLENUM) CABLE
 INTERFACE PER MIL-STD-348, SECTION 301.1

SUGGESTED STRIPPING INSTRUCTIONS
SUGGESTED CRIMP: .128

| ITEM | DESCRIPTION | QTY | MATERIAL | FINISH |
|------|-------------------|-----|-------------|--------|
| 13 | BACK NUT | 1 | BRASS | SILVER |
| 12 | WASHER | 1 | BRASS | SILVER |
| 11 | GASKET | 1 | S.I. RUBBER | RED |
| 10 | CLAMP | 1 | BRASS | SILVER |
| 9 | PRESS FIT WASHER | 1 | BRASS | SILVER |
| 8 | SHELL | 1 | BRASS | SILVER |
| 7 | WASHER | 1 | BRASS | SILVER |
| 6 | SPRING | 1 | SK-5 | SILVER |
| 5 | SPLIT LOCK WASHER | 1 | BRASS | SILVER |
| 4 | GASKET | 1 | S.I. RUBBER | RED |
| 3 | DIELECTRIC | 1 | PTFE | NONE |
| 2 | PIN | 1 | BRASS | GOLD |
| 1 | BODY | 1 | BRASS | SILVER |

DIMENSIONS ARE IN INCHES AND [MILLIMETERS]

UNLESS OTHERWISE NOTED TOLERANCES ARE:
DECIMALS DIAMETER

DRAWN C. ZUNIGA 8/25/99

CHECKED

ORJ DRAWN C. ZUNIGA 8/25/99

APPROVALS DATE

RF connectors
DIVISION OF RF INDUSTRIES, LTD.

7610 MIRAMAR RD
SAN DIEGO, CA 92126
(858) 549-6340
(858) 549-6345 FAX

RFB-1101-PL

BNC MALE CLAMP

| SIZE | CABLE GROUP | DWG NO. | REV |
|------------|------------------|--------------|-----|
| A | PL | 9235 | A |
| SCALE: 2:1 | CAD FILE 13ARC B | SHEET 1 OF 1 | |