

1.0 PERFORMANCE: (see level)  
 1.1 FREQUENCY RANGE DC-20 GHz  
 1.2 VSWR: 1.22 MAX (-20 dB)  
 1.18 TYPICAL (-21.7dB)  
 1.3 SYSTEM IMPEDANCE 50 OHMS  
 1.4 DWV: 500 Vrms @ 60 Hz  
 1.5 VOLTAGE RATING: 175 VRMS  
 1.6 TEMP RANGE: -65 / +165 °C

2.0 MATERIALS  
 2.1 CONTACT: BeCu  
 2.2 LOCKING RING: BeCu  
 2.3 COUPLING NUT:  
 STAINLESS STEEL (-GJP)  
 BRASS (-AG)  
 2.4 CRIMP FERRULE: SOFT COPPER  
 2.5 BODY: BRASS  
 2.6 INSULATOR: PTFE  
 2.7 GASKET: SI RUBBER  
 3.0 FINISHES: SEE TABLE

4.0 MECHANICAL  
 4.1 INTERFACES PER MIL-STD-348  
 4.2 COUPLING PROOF TORQUE 15 INCH\*LBS  
 4.3 COUPLING NUT RETENTION 60 LBS AXIAL  
 4.4 CONTACT RETENTION 6 LBS AXIAL  
 4.5 DURABILITY: 100 CYCLES

CRIMP HEX SIZE: .151

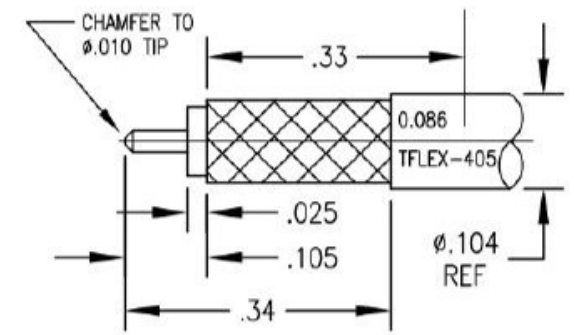

STAMP PER ORDER

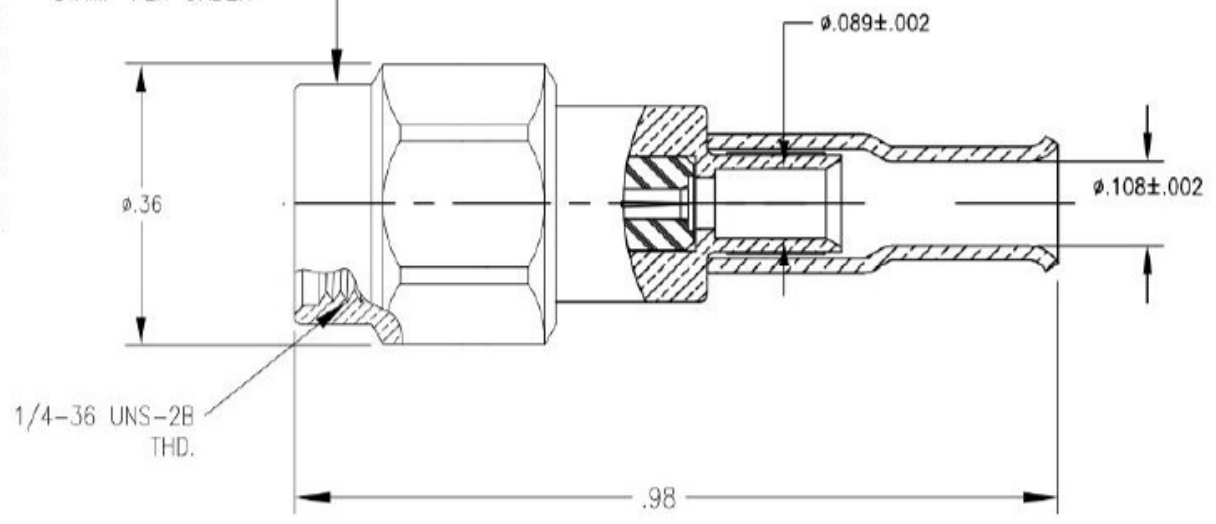

ASSEMBLY INSTRUCTIONS:

- 1) WINDOW STRIP JACKET AT 0.08 THRU 0.34
- 2) PRE-TIN THE BRAID USING MINIMUM SOLDER
- 3) STRIP BRAID AT 0.105
- 4) STRIP CENTER CONDUCTOR LEAVING .025 DIELECTRIC
- 5) POINT CENTER CONDUCTOR
- 6) FIXTURE SMA INTERFACE WITH TOOL 1209-03-P
- 7) INSERT CABLE FULLY INTO CONNECTOR BODY
- 8) APPLY HEAT TO CONNECTOR BODY ONLY AND SOLDER BRAID
- 9) LIMIT SOLDER WICKING TO 0.33
- 10) SLIDE CRIMP FERRULE INTO PLACE AND CRIMP

NOTE	PART NUMBER	BODY	CONTACT	C-NUT
STD	1201-27-GJP	Au/Cu	Au/Ni	PASSIVATE SS-303
PIM	1201-27-AG	ALBALOY	Au/Cu	ALBALOY BRASS
QUICKMATE	1201-27 M1-GJP	Au/Cu	Au/Ni	PASSIVATE SS-303

Rev.	Revisions	Disp.	Date	Dwn.	Appd.
F	ISSUE 1201-27-AG	NEW	5/26/11	FSH	FSH
E	UPDATE PROCEDURES	MIX	7/19/07	FSH	FSH
D	UPDATE CONNECTOR ELECTRICAL PERFORMANCE PER ACTUAL TEST RESULTS	MIX	6/21/07	DVP	FSH
C	IMPLEMENT IMPROVED CABLE PREP	MIX	4/12/07	FSH	FSH
B	OMIT .030 EXPOSED CORE ON CABLE BACKEND.	MIX	5/11/06	DVP	FSH
A	ORIGINAL	NEW	1/3/05		

THIS DRAWING CONTAINS CONFIDENTIAL INFORMATION PROPRIETARY TO SAN-TRON INC. IT MUST NOT BE REPRODUCED OR DISCLOSED TO OTHERS OR USED IN ANY OTHER WAY, IN WHOLE OR PART EXCEPT AS AUTHORIZED IN WRITING BY SAN-TRON INCORPORATED.

UNLESS OTHERWISE SPECIFIED:  
 ALL DIMENSIONS ARE IN INCHES.  
 ALL DIMENSIONS ARE AFTER PLATING.  
 .XXX = ±.005 ALL MACHINED SURFACES 63/ MAX.  
 .XX = ±.01 ANG. ±1/2' FRACTIONAL = ±1/64  
 ◎.004 MAX. TIR ⊥ AXIS .001

DWN	LAP	1/3/05
CHKD	SJS	X
APPR	FSH	1/3/05

**SAN-TRON, INC.**  
 4 NEWBURYPORT TPK. IPSWICH MA USA 01938  
 TEL: 978-356-1585 FAX: 978-356-1573  
 WWW.santron.com E MAIL: santron@santron.com

TITLE eSMA PLUG, STRAIGHT, EZ STYLE, TFLEX-405, SS-405 (Ø.086)	
MATERIAL: SEE NOTE 2.0	FINISH: SEE NOTE 3.0
CAGE CODE: 50896	DWG NO. OL-1201-27-1
SCALE 4:1	REV. F

DO NOT SCALE DRAWING