

CATALOG NUMBER

0118-919-4

MATERIAL AND FINISH

HOUSING AND BUSHING:

CRES 303; PASSIVATED

PIN AND CONTACT:

BeCu; GOLD PLATE 50-100 MICROINCHES OVER NICKEL PLATE 50 MICROINCHES MIN.

DIELECTRICS:

VIRGIN PTFE

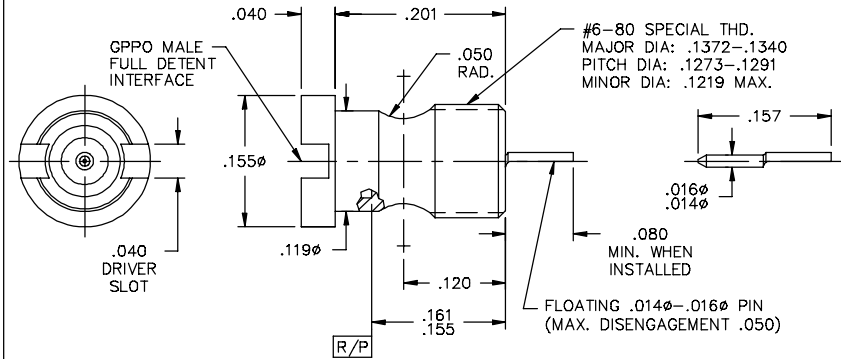
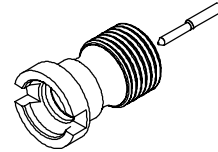

RECOMMENDED MOUNTING HOLE

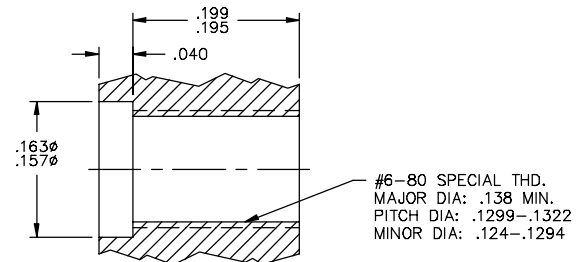

This drawing and any data contained herein is the property of Corning Gilbert Inc., and constitutes and contains proprietary and confidential information. Neither receipt nor possession of this drawing confers or transfers any right to duplicate, use or disclose any information contained herein except as expressly authorized by Corning Gilbert Inc.

GPPO MALE FULL DETENT
THREAD-IN TO STRIPLINE
LAUNCH WITH .015 ϕ OFFSET PIN

IDENT CODE:
82316
REVISION: A

Corning Gilbert Inc.

SOURCE FILE: SK-2380

DWG. NO.: OL-0118-919-4

ASSY. PROC.: -