

DATE REVISED: 5/1/02

CATALOG NUMBER

A015-D11-02

MATERIAL AND FINISH

CENTER CONTACT, HOUSING, PLUG, AND EMI/ANTI-ROCK RING: BeCu; GOLD PLATE 50-100 MICROINCHES OVER NICKEL PLATE 50 MICROINCHES MIN.

DIELECTRIC: VIRGIN PTFE (TEFLON)

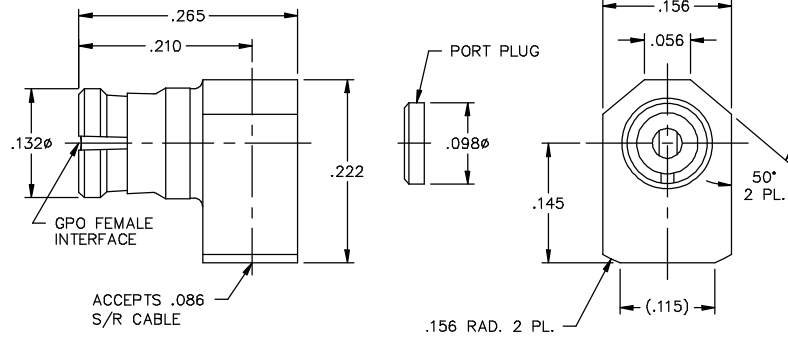
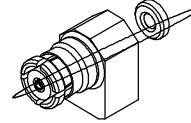

This drawing and any data contained herein is the property of Corning Gilbert Inc., and constitutes and contains proprietary and confidential information. Neither receipt nor possession of this drawing confers or transfers any right to duplicate, use or disclose any information contained herein except as expressly authorized by Corning Gilbert Inc.

GPO FEMALE
R/A TO .086
S/R CABLE

IDENT CODE:
82316
REVISION: B

Corning Gilbert Inc.

SOURCE FILE: MECR# 1995

DWG. NO.: OL-A015-D11-02

ASSY. PROC.: AP01-128