

CATALOG NUMBER	"A" INTERFACE
A001-D83-02	FULL DETENT
A001-D84-02	LIMITED DETENT
A001-D85-02	SMOOTH BORE

MATERIAL AND FINISH

HOUSING: CRES 303; PASSIVATED
 CENTER CONDUCTOR, BeCu; GOLD PLATE 50-100 μ INCHES
 AND CABLE ADAPTOR: OVER NICKEL PLATE 50 μ INCHES MIN.
 DIELECTRIC: VIRGIN PTFE (TEFLON)
 DIELECTRIC STOP: TORLON (POLYAMIDE-IMIDE)

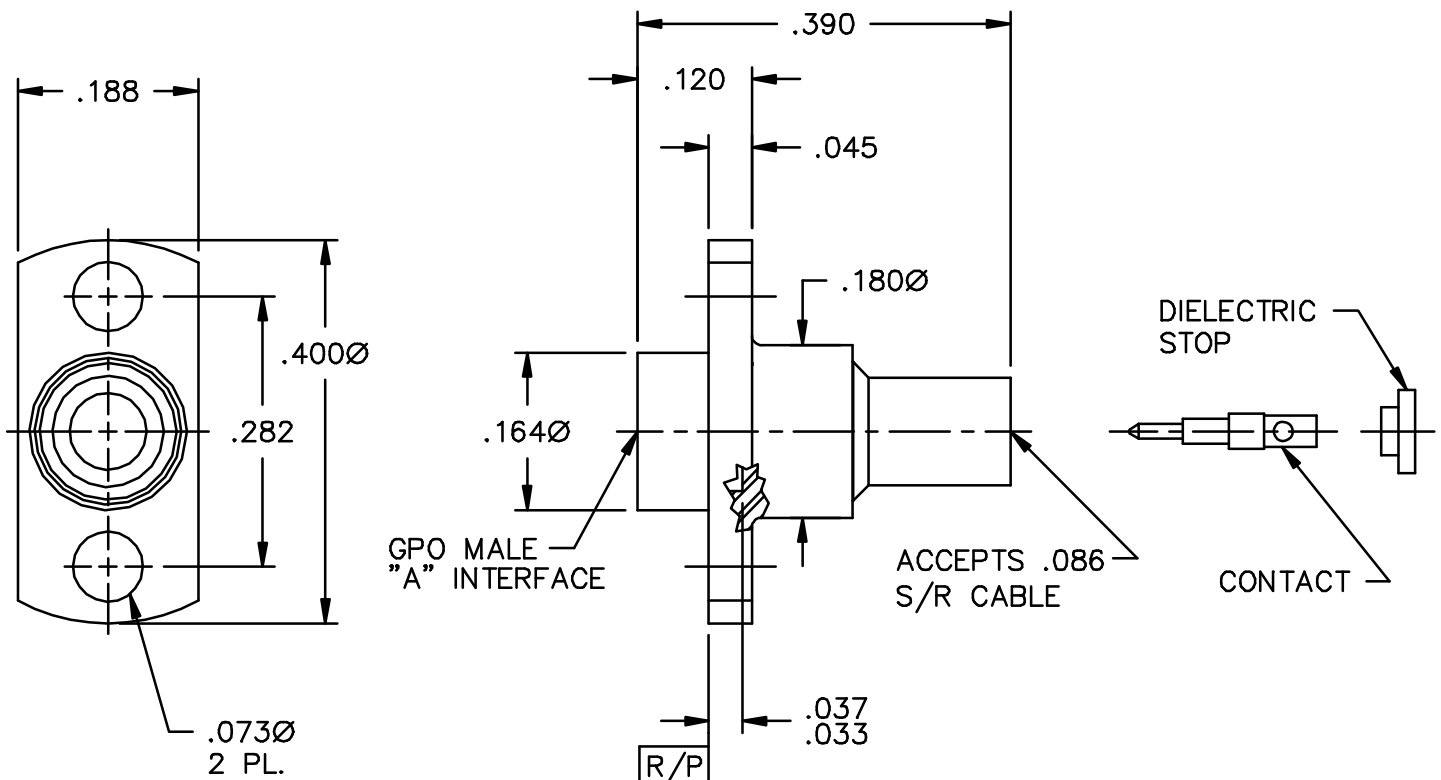
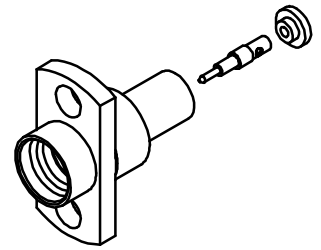

GPO MALE 2 HOLE FLANGE
 MOUNT TO .086 S/R
 CABLE (TAB DETENT)

IDENT CODE:
 82316

REVISION: A

**GILBERT
 ENGINEERING**

SOURCE FILE: MECR# 1916

DWG. NO.: OL-A001-D8X-02

ASSY. PROC.: AP01-015