

CATALOG NUMBER	"A" INTERFACE
A001-D83-01	FULL DETENT
A001-D84-01	LIMITED DETENT
A001-D85-01	SMOOTH BORE

A001-D83-01	FULL DETENT
A001-D84-01	LIMITED DETENT
A001-D85-01	SMOOTH BORE

MATERIAL AND FINISH

HOUSING: CRES 303; PASSIVATED
 CENTER CONDUCTOR, BeCu; GOLD PLATE 50-100 MICRONS
 AND CABLE ADAPTER: OVER NICKEL PLATE 50 MICRONS MIN.
 DIELECTRIC: VIRGIN PTFE (TEFLON)
 DIELECTRIC STOP: TORLON (POLYAMIDE-IMIDE)

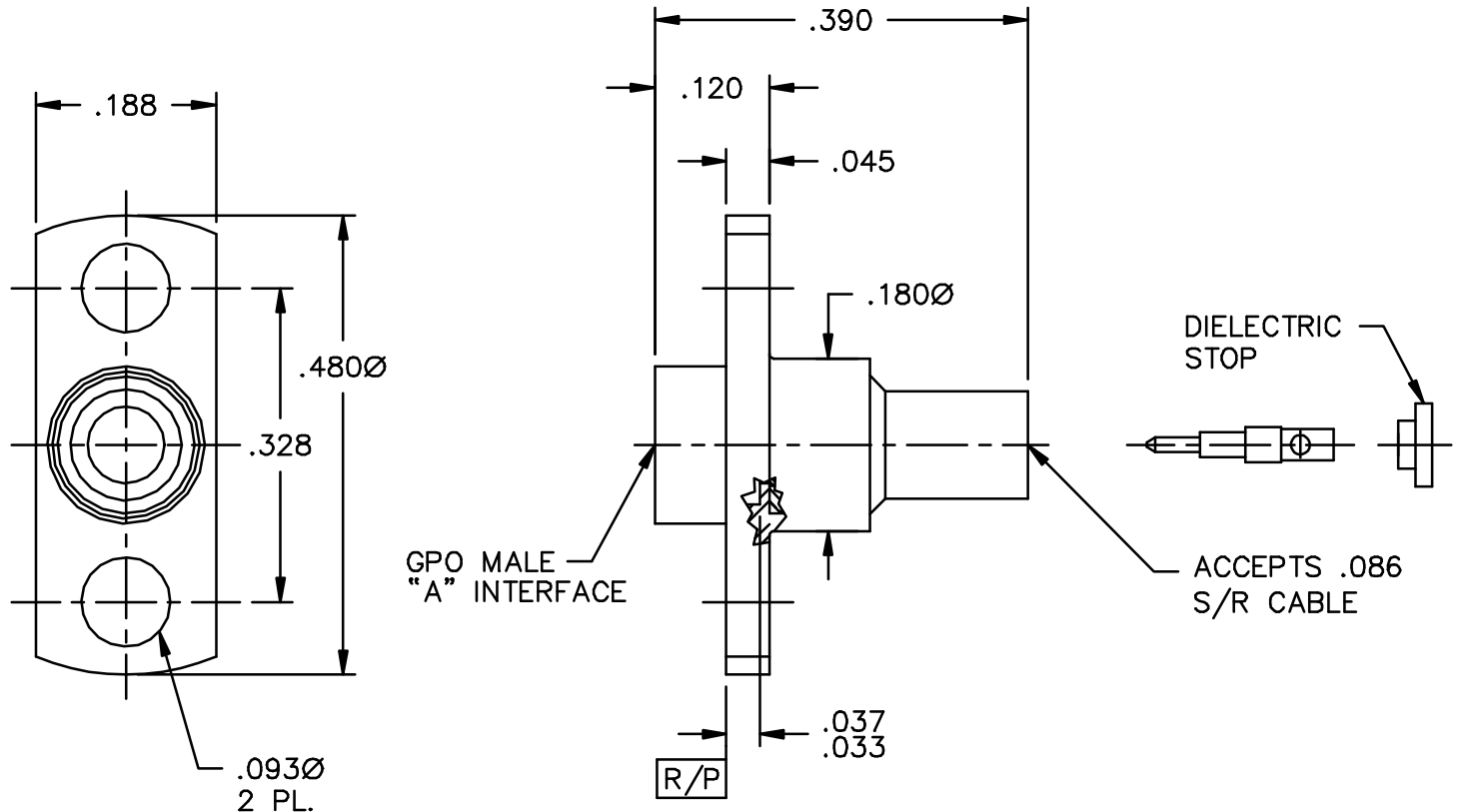
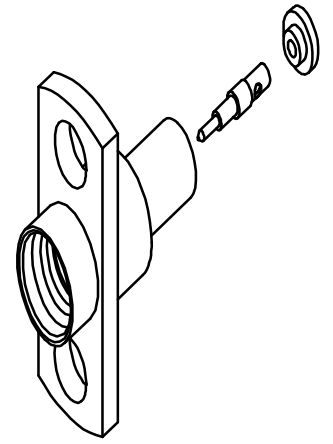

This drawing and any data contained herein is the property of Corning Gilbert Inc., and constitutes and contains proprietary and confidential information. Neither receipt nor possession of this drawing confers or transfers any right to duplicate, use or disclose any information contained herein except as expressly authorized by Corning Gilbert Inc.

GPO MALE 2 HOLE FLANGE
 MOUNT TO .086 S/R
 CABLE (TAB DETENT)

IDENT CODE:
82316

REVISION: A

Corning Gilbert Inc.

SOURCE FILE: MECR# 2271

DWG. NO.: OL-A001-D8X-01

ASSY. PROC.: IS-7051-9