

CATALOG NUMBER	"A" INTERFACE
A001-D83-02	FULL DETENT
A001-D84-02	LIMITED DETENT
A001-D85-02	SMOOTH BORE

## MATERIAL AND FINISH

HOUSING: CRES 303; PASSIVATED  
 CENTER CONDUCTOR, BeCu; GOLD PLATE 50-100  $\mu$  INCHES  
 AND CABLE ADAPTOR: OVER NICKEL PLATE 50  $\mu$  INCHES MIN.  
 DIELECTRIC: VIRGIN PTFE (TEFLON)  
 DIELECTRIC STOP: TORLON (POLYAMIDE-IMIDE)

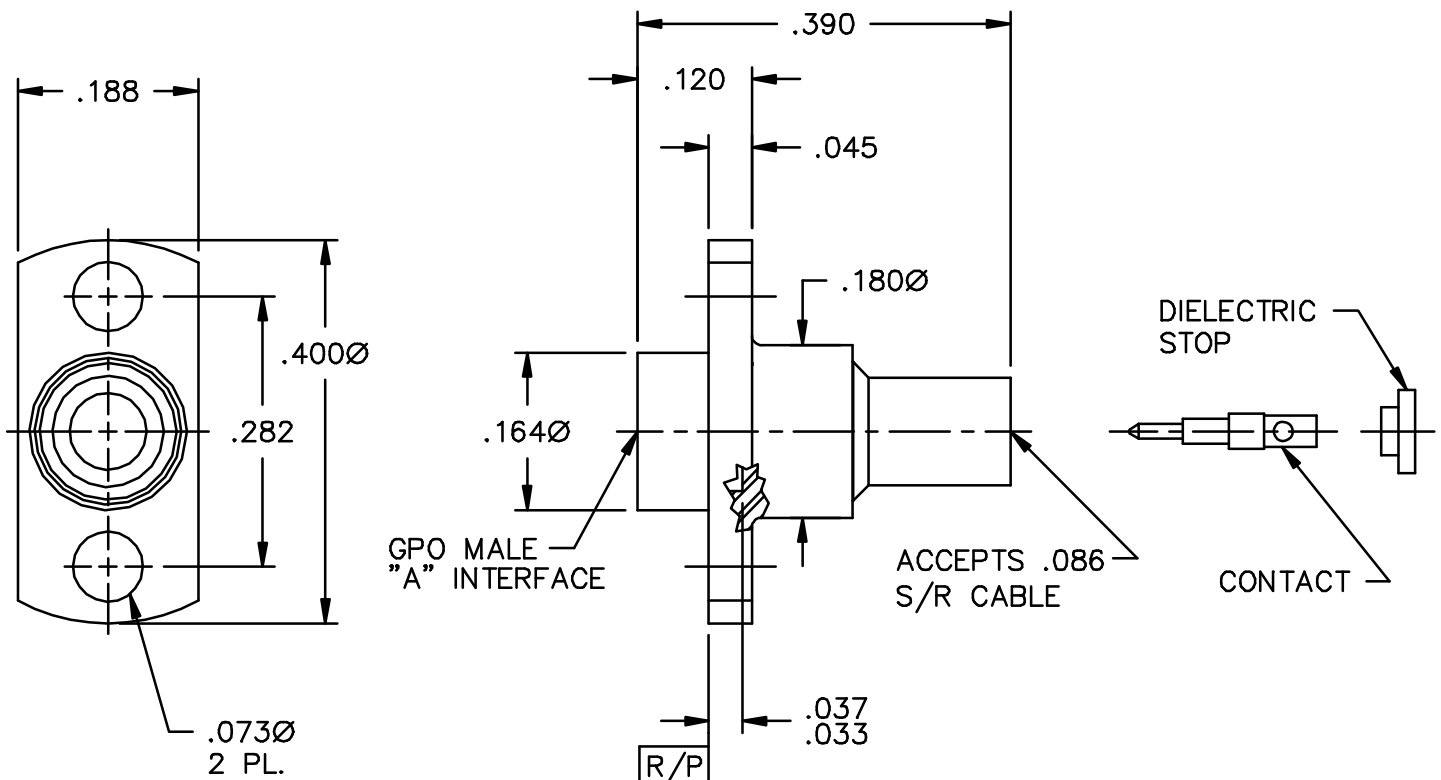
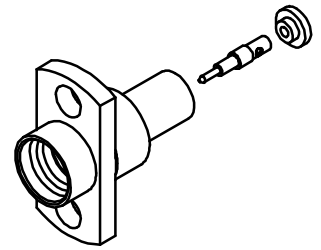

GPO MALE 2 HOLE FLANGE  
 MOUNT TO .086 S/R  
 CABLE (TAB DETENT)

IDENT CODE:  
 82316

REVISION: A

**GILBERT  
 ENGINEERING**

SOURCE FILE: MECR# 1916

DWG. NO.: OL-A001-D8X-02

ASSY. PROC.: AP01-015