

CATALOG NUMBER

0119-881-1

MATERIAL AND FINISH

HOUSING, EMI/ANTI-ROCK RING, AND CENTER CONTACT:

BeCu; GOLD PLATE 50-100 ? INCHES OVER NICKEL PLATE 50 ? INCHES MIN.

DIELECTRIC:

VIRGIN PTFE (TEFLON)

DIELECTRIC STOP:

TORLON (POLYAMIDE-IMIDE)

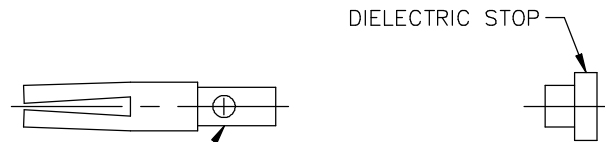
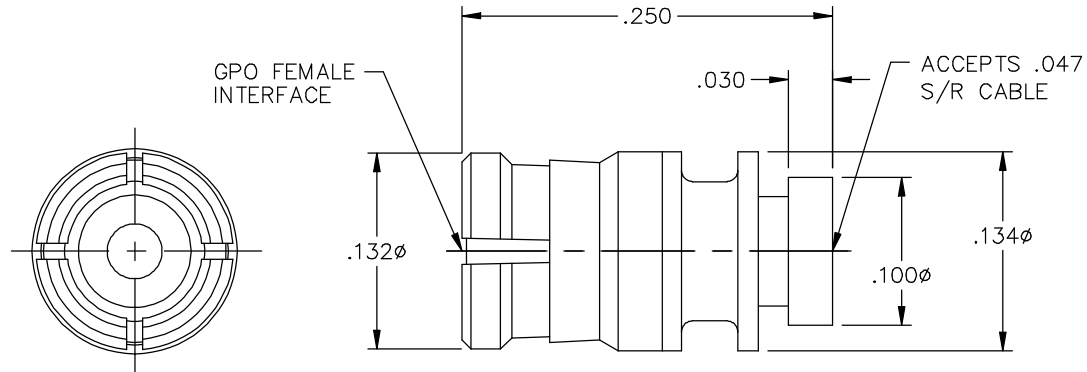
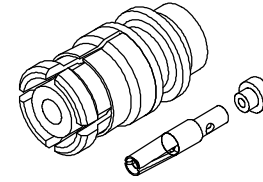

CONTACT SOLDER TO CABLE CENTER CONDUCTOR

GPO FEMALE STRAIGHT TO .047 S/R CABLE SOLDER ATTACH C/C

IDENT CODE: 82316

REVISION: C

GILBERT ENGINEERING

SOURCE FILE: MECR# 388

DWG. NO.:

OL-0119-881-1

ASSY. PROC.: AP01-002