

ENVELOPE / ASSEMBLY DRAWING

000000

SPECIFICATION CONTROL DRAWING		REV	DESCRIPTION	DWN	DATE	APPROVED
THIS DRAWING CONTAINS INFORMATION PROPRIETARY TO RF INDUSTRIES, LTD. ANY UNAUTHORIZED USE OF THIS DRAWING IS EXPRESSLY PROHIBITED. ANY VIOLATION IS PUNISHABLE UNDER U.S. COPYRIGHT LAWS.		F	CHANGE SHELL CONFIGURATION & FERRULE STUD ID	KMM	7/12/94	R. RICE
		G	UPDATE DRAWING	CZS	3/23/98	R. RICE
		H	STANDARDIZE SHELL & DIE/CHG BODY DIMS & CORRECT FER ID	CZS	4/1/99	R. RICE
		J	CHANGE FERRULE STUD CONFIGURATION	CZS	6/8/00	J. D. McR.

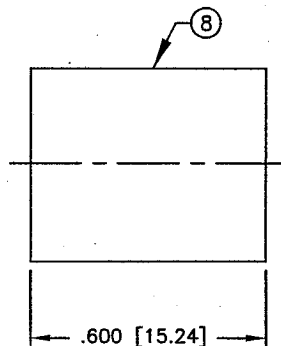
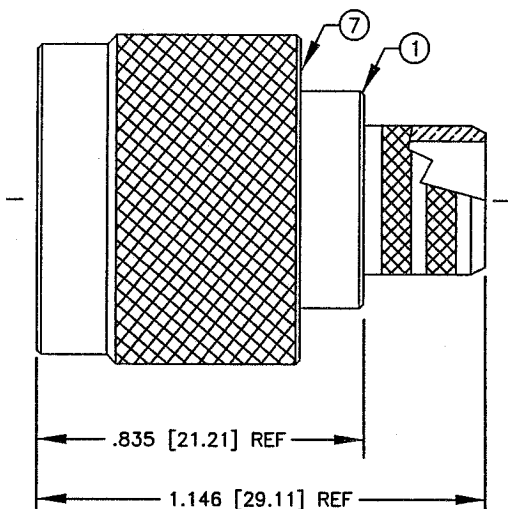

ALL DIMENSIONS ARE REFERENCE ONLY

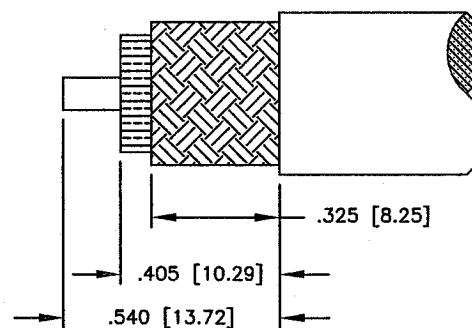
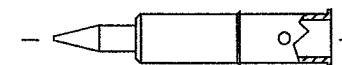

SPECIFICATIONS:

IMPEDANCE: 50 OHMS
 WORKING VOLTAGE: 1000 VRMS @ SEA LEVEL
 FREQUENCY RANGE: 0-11 GHz
 INSERTION LOSS: ≤ -0.2 dB @ 10 GHz
 VSWR MAX: 1.3:1 @ 9 GHz
 FOR RG-8, 8A, 213/U, BELDEN 8237, 8267, 9251 & 9880
 INTERFACE PER MIL-STD-348, SECTION 304.1

SUGGESTED STRIPPING INSTRUCTIONS

SUGGESTED CRIMP: .100 & .429

DIMENSIONS ARE IN INCHES AND [MILLIMETERS]
 UNLESS OTHERWISE NOTED TOLERANCES ARE:
 DECIMALS DIAMETER

RF connectors
 DIVISION OF RF INDUSTRIES, LTD.

7610 MIRAMAR RD
 SAN DIEGO, CA 92126
 (858) 549-6340
 (858) 549-6345 FAX

ITEM	DESCRIPTION	QTY	MATERIAL	FINISH
8	FERRULE [FER-205]	1	BRASS	SILVER
7	SHELL	1	BRASS	SILVER
6	RETAINING RING	1	BRASS	NONE
5	GASKET	1	S.I. RUBBER	RED
4	GROUND RING	1	BRASS	SILVER
3	DIELECTRIC	1	TEFLON	NONE
2	PIN [PIN-305-10]	1	BRASS	GOLD
1	BODY	1	BRASS	SILVER

DRAWN C. ZUNIGA	6/8/00
CHECKED <i>[Signature]</i>	4-17-01
ORJ DRAWN S. SMITH	6/29/90
APPROVALS	DATE

RFN-1006-3E

N MALE CRIMP

SIZE A	CABLE GROUP E	DWG NO. 8101	REV J
SCALE: 2:1	CAD FILE	SHEET 1 OF 1	