

DWG NO. OL-0401-128-1		REV. A
PART NUMBER 0401-128	BODY NICKEL	CONTACT SILVER

PLATING PER SAN-TRON SPEC. 7.3.1-8

- 1.0 PERFORMANCE
- 1.1 VOLTAGE RANGE: 1000V RMS (sea level)
- 1.2 NOMINAL IMPEDANCE: 50 OHMS
- 1.3 DWV: 2500V RMS @ 60Hz (sea level)
- 1.4 TEMPERATURE RANGE: -65°C TO +165°C
- 2.0 MATERIALS
- 2.1 DIELECTRIC: PTFE
- 2.2 CENTER CONTACT: BRASS

- 2.3 LOCKING RING: PHOS BRONZE
- 2.4 ALL OTHER METAL PARTS: BRASS
- 2.5 GASKET: SI RUBBER
- 3.0 FINISHES
- 3.1 CENTER CONTACT: SEE TABLE
- 3.2 ALL OTHER METAL PARTS: SEE TABLE
- 4.0 MECHANICAL
- 4.1 INTERFACE IN ACCORDANCE WITH MIL-STD-348
- 4.2 USE SANTRON ASSEMBLY INSTRUCTION B-12

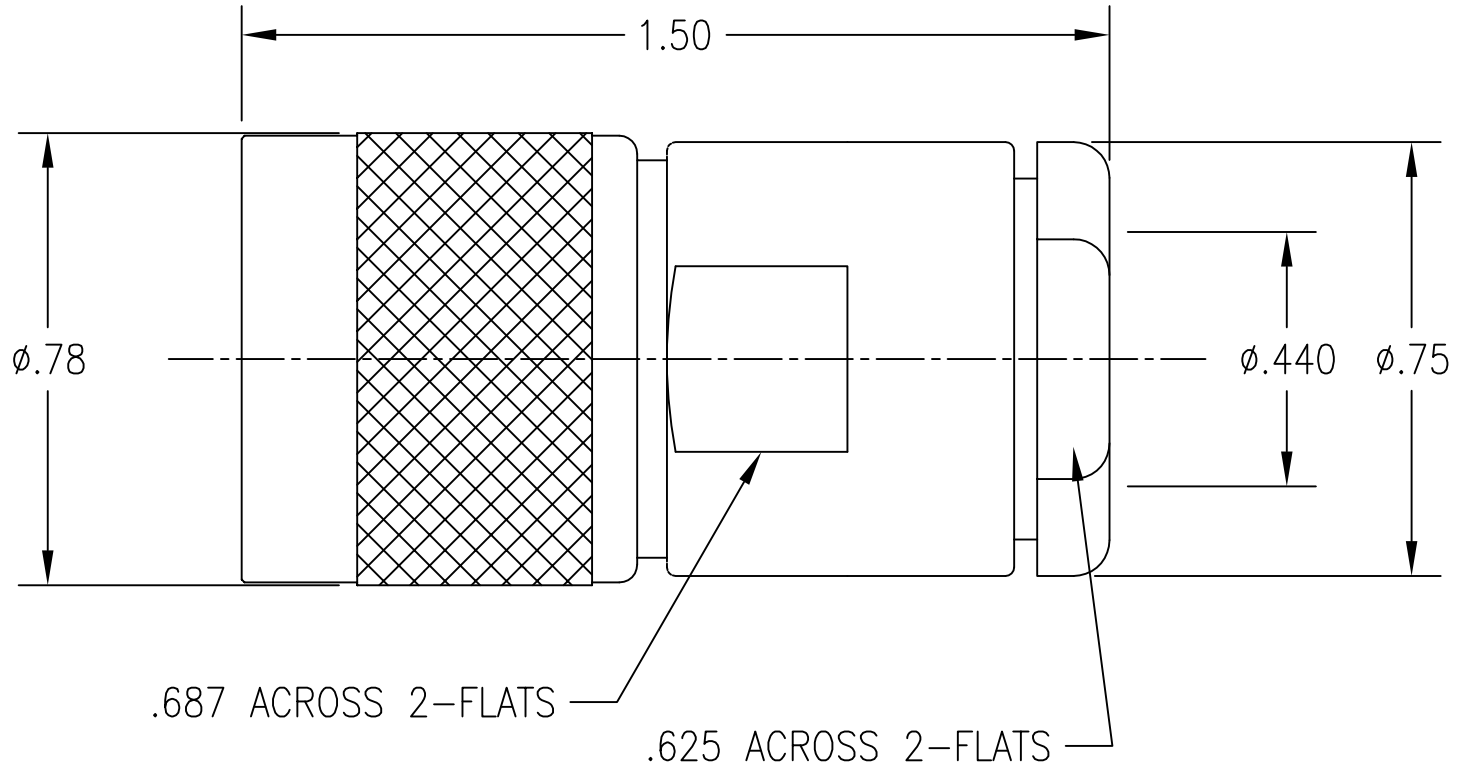

THIS DRAWING CONTAINS CONFIDENTIAL INFORMATION PROPRIETARY TO SAN-TRON, INC. IT MUST NOT BE REPRODUCED OR DISCLOSED TO OTHERS OR USED IN ANY OTHER WAY, IN WHOLE OR PART EXCEPT AS AUTHORIZED IN WRITING BY SAN-TRON, INC.

UNLESS OTHERWISE SPECIFIED:
ALL DIMENSIONS ARE IN INCHES.
ALL DIMENSIONS ARE AFTER PLATING.
.XXX = ±.005 ALL MACHINED SURFACES 64/ MAX.
.XX = ±.01 ANG. ±1/2' FRACTIONAL = ±1/64

⓪ .004 MAX. TIR. ⊥ AXIS .001



SAN-TRON, INC.

4 NEWBURYPORT TPK. IPSWICH MA USA 01938
TEL: 978 - 356 -1585 FAX: 978 - 356 -1573
WWW. santron.com E MAIL: santron@santron.com

TITLE

TYPE N PLUG, FOR RG8, RG9

MATERIAL:
SEE NOTES

FINISH:
SEE TABLE

CAGE CODE: 50896

DWG NO.
OL-0401-128-1

REV.
A

SCALE X:X

DO NOT SCALE DRAWING

Rev.	Revisions	Disp.	Date	Dwn.	Appd.
A	OUTLINE RELEASE	NEW	7/16/10		
Ref.:	REMOVE ALL BURRS AND SHARP EDGES .005 MAX.	INTERPRET PER ASME Y14.5M-1994			
SK-					

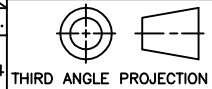

DWN	JTH	7/16/10
CHKD		
APPR		