

SHV8100-0142

SHV Jack Crimp

50Ω

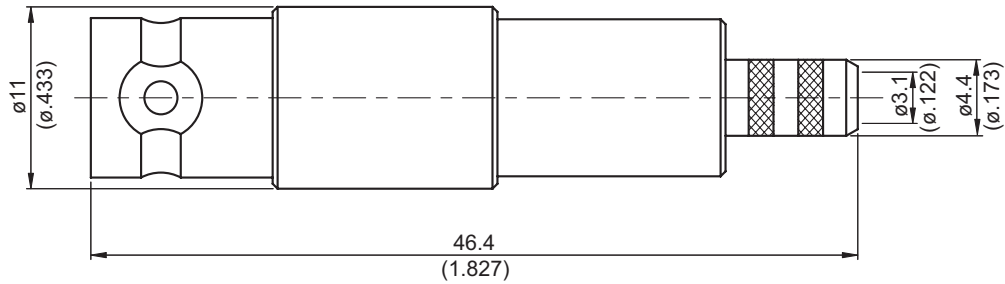

Parts	Material	Plating(Micro-inch)
Contact Pin	Brass	Gold 10 Over Nickel 50 Over Copper 50
Ferrule	Brass	Tin-Zinc-Copper-Alloy 100 Over Copper 50
Barrel	Brass	Tin-Zinc-Copper-Alloy 100 Over Copper 50
Insulator	Teflon	
Body	Brass	Tin-Zinc-Copper-Alloy 100 Over Copper 50

Weight:





Suitable Cables: RG55, RG142, RG400, RG142-E

This part number complies with RoHS.

Notice: JYEBAO reserves the right to make modification deemed appropriate.

JYE BAO CO., LTD.

CABLE ASSEMBLY INSTRUCTION

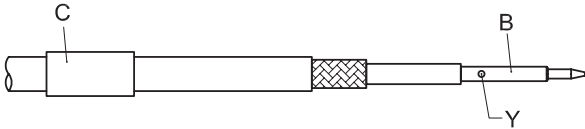
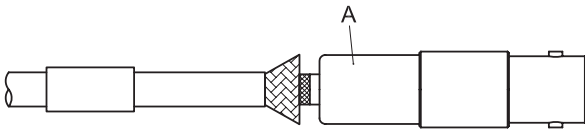
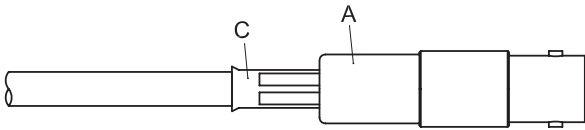
SHV8100-0142		DATE	2014/09/01	REV	—
A	B	C			
					
BODY	CONTACT PIN	FERRULE			
DIAGRAM		ASSEMBLY INSTRUCTION			
		Step 1: STRIP AS SHOWN.			
		Step 2: SLIDE FERRULE " C " OVER CABLE. Step 3: PUT PIN " B " ON CENTER CONDUCTOR AND SOLDER OR CRIMP IN " Y ". (USE SQUARE 1.6mm/0.063inch SECTION OF INSERT-B IF CRIMPED)			
		Step 4: LOOSEN BRAIDING AND SLIDE CONNECTOR " A " IN PLACE.			
		Step 5: SLIDE FERRULE " C " TOWARDS THE CONNECTOR " A " AND CRIMP. (USE 5.5mm/0.217inch HEX SECTION OF INSERT-B)			
This part number complies with RoHS. Notice: JYEBAO reserves the right to make modifications deemed appropriate.					
APPROVED		CHECKED		DRAWING	
				<i>Albert</i>	