

DWG NO. OL-1206-03-1		REV. 1
PART NUMBER 1206-03	BODY SILVER	CONTACT Au/Cu

PLATING PER SAN-TRON SPEC. 7.3.1-8

- 1.0 PERFORMANCE:
 1.1 FREQUENCY RANGE DC-18 GHz
 1.3 SYSTEM IMPEDANCE 50 OHMS
 1.4 DWV: 1500 Vrms @ 60 Hz (SEA LEVEL)
 1.5 VOLTAGE RATING: 500 Vrms (SEA LEVEL)
 1.6 TEMP RANGE: -65 / +165 °C

- 2.0 MATERIALS
 2.2 SOCKET CONTACT: BeCu
 2.4 OTHER METAL PARTS: BRASS
 2.5 INSULATOR: PTFE
 3.0 FINISHES: SEE CHART

- 4.0 MECHANICAL
 4.1 INTERFACES PER MIL-STD-348
 4.4 CONTACT RETENTION 6 LBS AXIAL
 4.5 INSULATOR RETENTION 6 LBS AXIAL
 4.6 DURABILITY: 100 CYCLES

DO NOT SCALE DRAWING

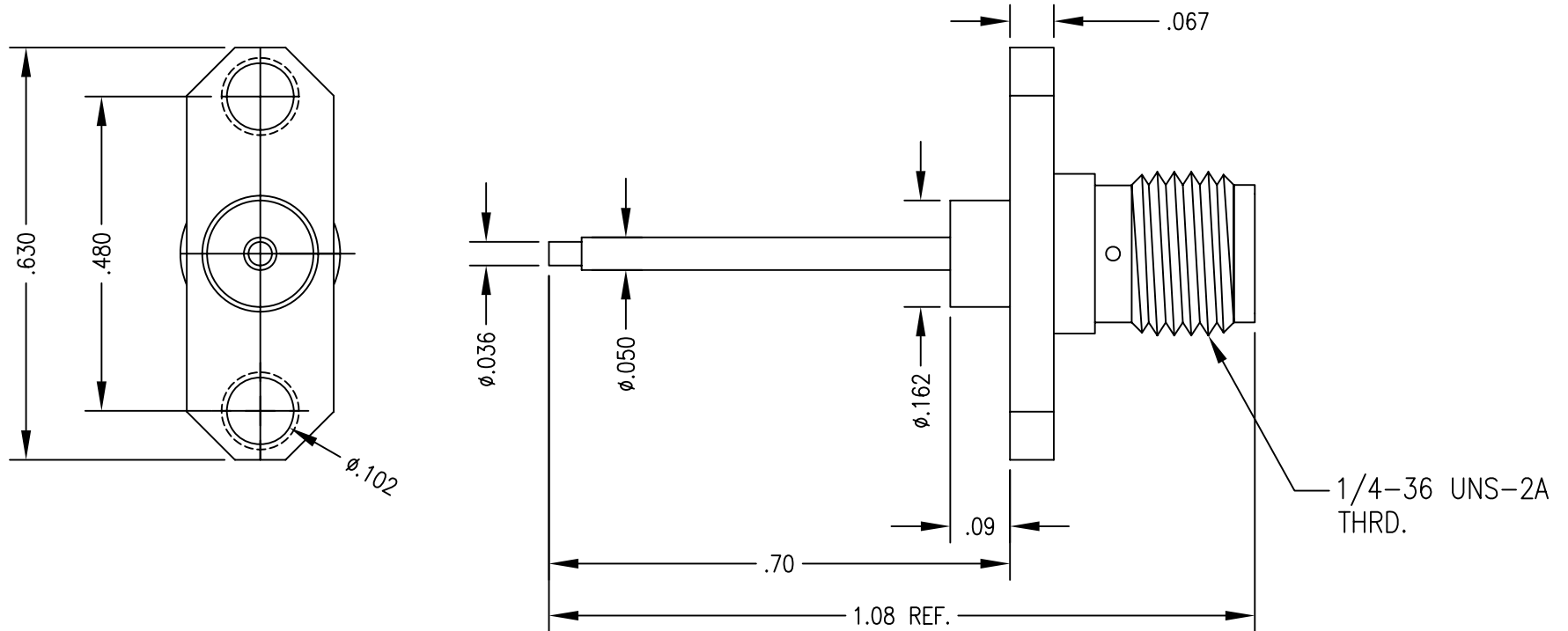

THIS DRAWING CONTAINS CONFIDENTIAL INFORMATION PROPRIETARY TO SAN-TRON, INC. IT MUST NOT BE REPRODUCED OR DISCLOSED TO OTHERS OR USED IN ANY OTHER WAY, IN WHOLE OR PART EXCEPT AS AUTHORIZED IN WRITING BY SAN-TRON, INC.

UNLESS OTHERWISE SPECIFIED:
 ALL DIMENSIONS ARE IN INCHES.
 ALL DIMENSIONS ARE AFTER PLATING.
 .XXX = ±.005 ALL MACHINED SURFACES $\sqrt{64}$ MAX.
 .XX = ±.01 ANG. ±1/2° FRACTIONAL = ±1/64
 ◎.004 MAX. TIR. ⊥ AXIS .001



SAN-TRON, INC.

4 NEWBURYPORT TPK. IPSWICH MA USA 01938
 TEL: 978 - 356 -1585 FAX: 978 - 356 -1573
 WWW.santron.com E MAIL: santron@santron.com

TITLE
 SMA, PANEL RECEPTACLE, 2 HOLE

MATERIAL:
 SEE NOTES FINISH:
 SEE TABLE

CAGE CODE: 50896 DWG NO. OL-1206-03-1 REV. 1
 SCALE X:X

1	PRELIMINARY: DO NOT MFG	NEW	3/13/09		
Rev.	Revisions	Disp.	Date	Dwn.	Appd.
	Ref.: SK-	REMOVE ALL BURRS AND SHARP EDGES .005 MAX.	INTERPRET PER ASME Y14.5M-1994		

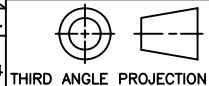

DWN	JTH	3/13/09
CHKD		
APPR	JTH	3/13/09