

REVISIONS			
REV	DESCRIPTION	DATE	APPROVED
-	INITIAL RELEASE	11/29/00	A.D.M.

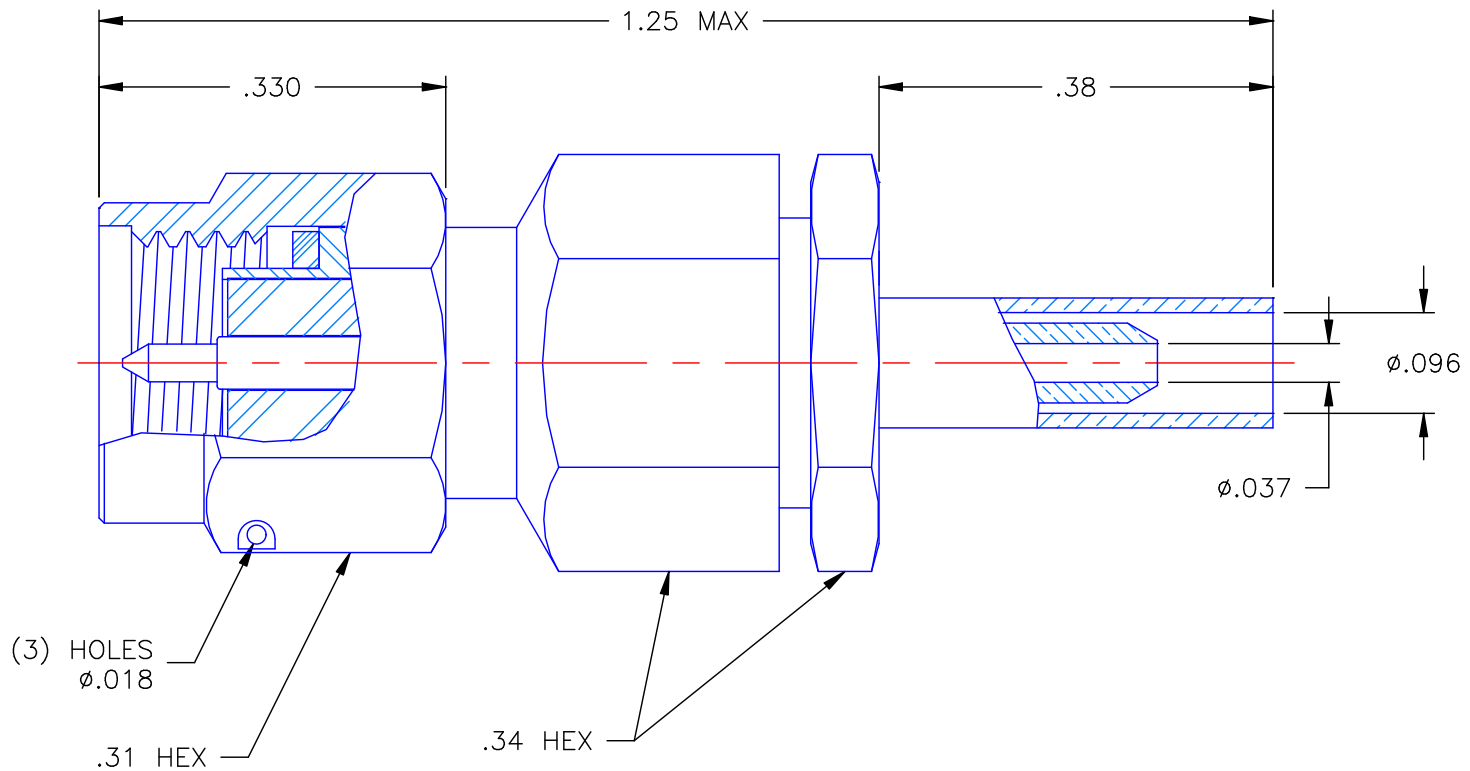

NOTES: CONFORMS TO MIL-PRF-39012/55-3025

MATERIALS:

1. BODY & COUPLING NUT = STAINLESS STEEL PER ASTM A582, ALLOY 303, CONDITION "A".
2. INSULATORS = VIRGIN WHITE TEFLON PER ASTM D1710, GRADE 1, TYPE I, CLASS "A".
3. CONTACT & RETAINING RING = BERYLLIUM COPPER PER ASTM B196, ALLOY C17300, TEMPER TD04.
4. CRIMP NUT & WASHER = BRASS PER ASTM B16, ALLOY C36000, TEMPER H02.
5. GASKET = SILICONE RUBBER PER ZZ-R-765, CLASS 2B, GRADE 65-75.
6. CRIMP SLEEVE = SEAMLESS COPPER TUBE PER ASTM B75, TYPE C12000, TEMPER: LIGHT ANNEAL O50 EXCEPT YIELD STRENGTH.
7. SHRINK SLEEVE = THERMOFIT SCL. (NOT SHOWN)

FINISHES:

1. CRIMP SLEEVE, CRIMP NUT, WASHER & RETAINING RING = NICKEL PLATE PER QQ-N-290, CLASS 1, GRADE G, EXCEPT .0001 TO .0002 THICK OVER .00005 TO .0001 THICK COPPER PER MIL-C-14550.
2. CONTACT = GOLD PLATE PER MIL-G-45204, TYPE II, CLASS 1, GRADE C, OVER .00010 TO .00020 STRESS FREE SULFAMATE NICKEL PER QQ-N-290.
3. ALL OTHER METAL PARTS = PASSIVATE PER QQ-P-35, TYPE VI.

UNLESS OTHERWISE SPECIFIED DIMENSIONS ARE IN INCHES TOLERANCES ON	DWN:	DATE	
	A.D.M.	11/28/00	
	CHKD:	DATE	
DECIMAL	ANGLE	D.N.	11/29/00
		APVD:	DATE
		D.J.C.	11/29/00

AEP APPLIED ENGINEERING PRODUCTS
 104 John W. Murphy Dr.
 New Haven, CT 06513

SMA, STRAIGHT PLUG
 SOLDER/CRIMP
 TO RG-178

REFERENCE:	MATERIALS & FINISHES:
ORIGINATOR: A.D.M. DATE: 11/28/00	SEE NOTES

SIZE	FSCM NO.	DWG NO.	REV
A	19505	9101-9573-902	-
SCALE 5:1		SHEET 1 OF 1	

9101-9573-902