

THIS DRAWING CONTAINS INFORMATION PROPRIETARY TO RF INDUSTRIES.  
 ANY UNAUTHORIZED USE OF THIS DRAWING IS EXPRESSLY PROHIBITED  
 WITHOUT WRITTEN PERMISSION FROM RF INDUSTRIES.  
 ANY VIOLATION IS PUNISHABLE UNDER U.S. COPYRIGHT LAWS.

ALL DIMENSIONS ARE REFERENCE ONLY

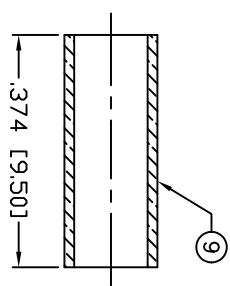

RECOMMENDED CRIMP DIE: .130"

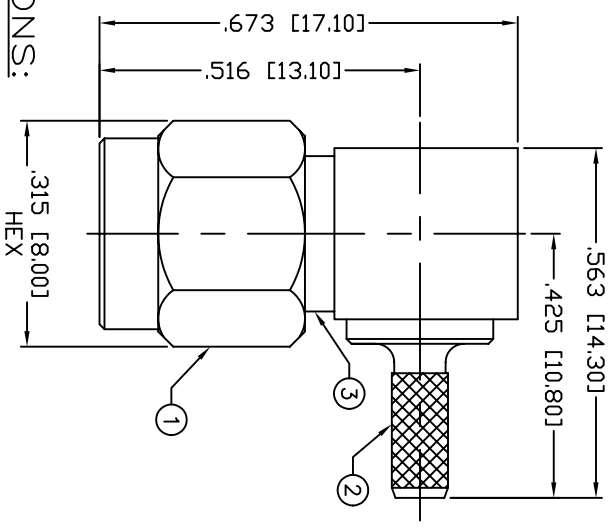
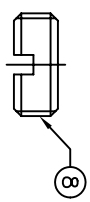
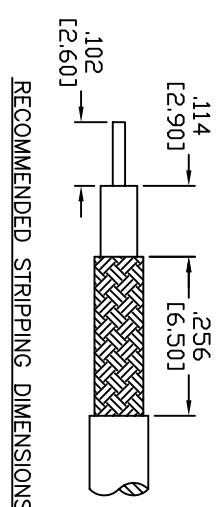

RECOMMENDED STRIPPING DIMENSIONS

NOTE: ATTACH CABLE TO CONNECTOR BY  
 SOLDERING THE CABLE INNER CONDUCTOR  
 TO THE PIN SLOT INSIDE THE CONNECTOR

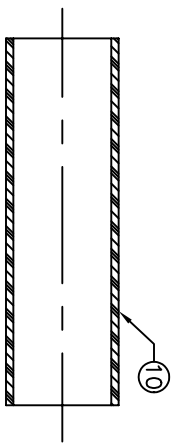

**SPECIFICATIONS:**

IMPEDANCE: 50 Ohms  
 FREQUENCY RANGE: 0-12.4 GHz  
 INSERTION LOSS(DB):  $0.07 \times \sqrt{f(\text{GHz})}$   
 VSWR: 1.3 MAX.  
 WORKING VOLTAGE: 375 V rms Max. @ Sea Level  
 INSULATION RESISTANCE: 5k M Ohms min.  
 TEMPERATURE RANGE: -65°C TO 85°C  
 FOR RG-174, 188, 188A, 316/U, ALPHA 9174, 9316,  
 BELDEN 8216, 83269, 83284, 84316 & TIMES LMR-100A CABLE

#	DESCRIPTION	QTY	MATERIAL	FINISH	APPROVALS	DATE
1	SHELL	1	BRASS	NICKEL, 100μ"	008974	
2	BODY	1	BRASS	NICKEL, 100μ"		
3	SMA BODY	1	BRASS	NICKEL, 100μ"		
4	INSULATOR	1	PTFE	---		
5	PIN	1	BRASS	GOLD, 50 μ"		
6	RETAINING RING	1	Be, Cu	---		
7	GASKET	1	SILICONE	---		
8	COVER	1	BRASS	NICKEL, 100μ"		
9	FERRULE	1	COPPER	NICKEL, 100μ"		
10	TUBING	1	HEAT SHRINK	---		
11					DRAWN C. ZUNIGA	4/7/05
12					CHECKED	
13					ORJ DRAWN K. MAXWELL	
14						3/9/94

UNLESS OTHERWISE SPECIFIED:

DIMENSIONS ARE IN INCHES  
 AND [MILLIMETERS]  
 UNLESS OTHERWISE NOTED  
 TOLERANCES ARE:  
 DECIMALS DIAMETER

PART NO.		DESCRIPTION			DWN	DATE	APPROVED
REV		ENGINEERING RELEASE		KMM	3/9/94	C. JONES	
A		ADD STRIPPING INST		KMM	1/16/96	R. RICE	
B		ADD FERRULE & FERRULE STUD ID DIMS		KMM	8/21/96	R. RICE	
C		UPDATE DWG & TITLE BLOCK		CZS	4/7/05	JDMc	

**RF connectors**  
 DIVISION OF RF INDUSTRIES, LTD.  
 7610 MIRAMAR RD  
 SAN DIEGO, CA 92126  
 (858) 549-6340  
 (858) 549-6345 FAX

**SMA PLUG, CRIMP**

RIGHT ANGLE

SIZE	CABLE GROUP	DWG NO.	REV
A	B	RSA-3010-B	D
SCALE:	NTS	CAD FILE	OUTLINE
SHEET	1	OF	1