

THIS DRAWING CONTAINS INFORMATION PROPRIETARY TO RF INDUSTRIES,
 ANY UNAUTHORIZED USE OF THIS DRAWING IS EXPRESSLY PROHIBITED
 WITHOUT WRITTEN PERMISSION FROM RF INDUSTRIES.
 ANY VIOLATION IS PUNISHABLE UNDER U.S. COPYRIGHT LAWS.

"DIMENSIONS ARE REFERENCE ONLY"

PART NO.

RP-3000-C

REV	DESCRIPTION	DWN	DATE	APPROVED
-	ENGINEERING RELEASE	JDM	7/99	JDMc
A	REMOVED CRIMP TOOL NOTE "USE RFA-4089"	JDM	3/25/03	JDMc

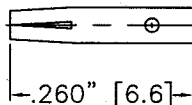
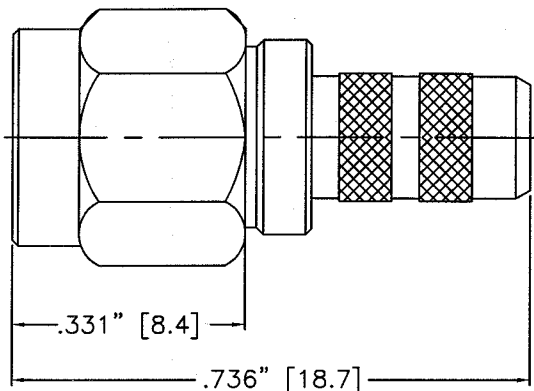

(SOCKET CONTACT)
 "SOLDER ONLY"

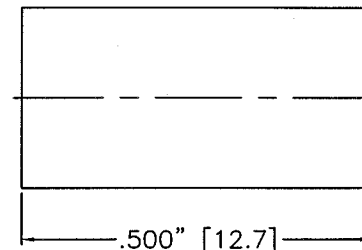

(FERRULE)
 USE CRIMP DIE .213

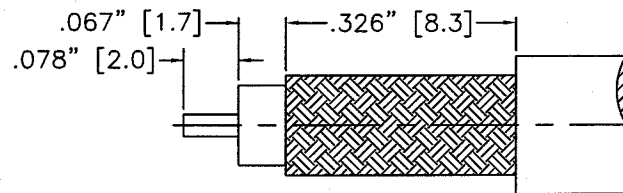

RECOMMENDED
 CABLE STRIPPING DIMENSIONS

SPECIFICATIONS:

IMPEDANCE RANGE: 50 Ohms
 FREQUENCY RANGE: DC to 12.4 GHz

FOR RG-58, 58A, 58C, 141, 141A, Belden 8219, 8240, 8259, 8262, 9201, 9203, 9310,
 9311; CommScope BWC-195, BWC-195R, Q268; Times LMR-195

NOTES: FINISH (PLATING THICKNESS IN MICRO-INCHES)

- BRASS PER QQ-B-626
- NICKEL PL. 100 MIN. THICK OVER COPPER STRIKE
- BERYLLIUM COPPER PER QQ-C-530
- GOLD PL. 50 MIN. THICK OVER NICKEL PL. 100 MIN. THICK OVER COPPER STRIKE
- TEFLON MIL-P-19468

UNLESS OTHERWISE SPECIFIED:

- REMOVE ALL BURRS
- BREAK ALL CORNERS & EDGES .005 R. MAX.
- CHAMFER 1ST & LAST THREADS 45°
- SURFACE ROUGHNESS 63 FINISH MIL-STD-10
- DIAMETERS ON COMMON CENTERS TO BE CONCENTRIC WITHIN .002 T.I.R.
- ALL DIMENSIONS ARE AFTER PLATING.

DIMENSIONS ARE IN INCHES
 AND [MILLIMETERS]

UNLESS OTHERWISE NOTED
 TOLERANCES ARE:

DECIMALS	DIAMETER
.XXX±.003 [.08]	.XXX±.001 [.03]
.XX±.005 [.13]	.XX±.003 [.08]

RF connectors
 DIVISION OF RF INDUSTRIES, LTD.

7610 MIRAMAR RD
 SAN DIEGO, CA 92126
 (619)549-6340
 (619)549-6345 FAX

SMA, REVERSE POLARITY

CRIMP, PLUG

SIZE	CABLE GROUP	DWG NO.	REV
A	C	RP-3000-C	A

SCALE: NTS

CAD FILE
 DETAIL

SHEET 1 OF 1

1	BODY	1	BRASS		 8974 DRAWN D. McREYNOLDS 3/25/03 CHECKED ORJ DRAWN D. McREYNOLDS 5/22/00
2	CONTACT	1	Be. Cu.		
3	INSULATOR	1	PTFE		
4	COUPLING NUT	1	BRASS		
5	RETAINING RING	1	Be. Cu.		
6	GASKET	1	SILICONE		
7	FERRULE	1	COPPER		
8					
#	DESCRIPTION	QTY	MATRL.	APPROVALS	DATE