

***** THIS DRAWING AND ITS CONTENTS ARE THE SOLE PROPERTY OF PRECISION CONNECTOR INC. AND ARE SUBJECT TO CHANGE WITHOUT NOTICE UNLESS OTHERWISE SPECIFIED *****

REV.	DESCRIPTION	DATE	BY	APPVD
A	INITIAL RELEASE	06/23/14	MJK	MJK

NOTE: DISTANCE FROM END OF CABLE CENTER COND. TO CENTERLINE IS .720

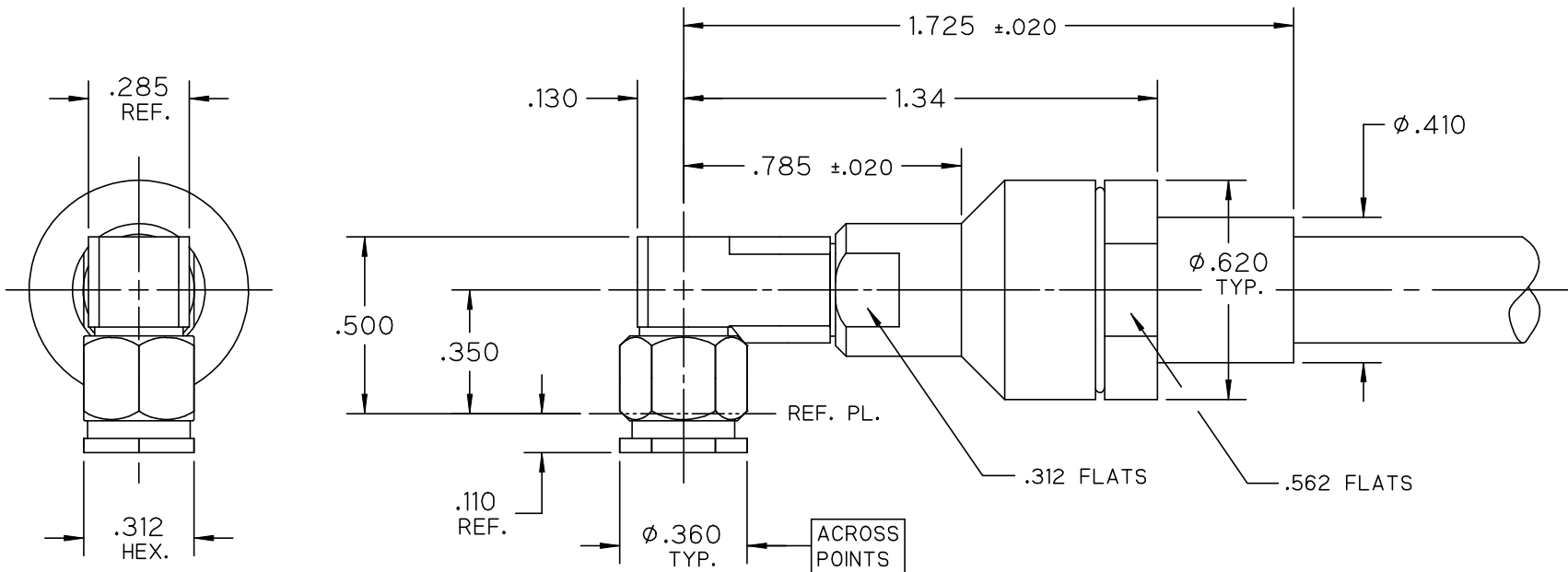

NOTES :

1.0 MATERIALS

- 1.1 BODY, COUPLING & CLAMP NUTS: STEEL, CORROSION RESISTANT PER ASTM-A582, UNS NO. S30300.
- 1.2 CENTER COND.: BERYLLIUM COPPER PER ASTM-B196, UNS C17300.
- 1.3 SOLDER FERRULE: BRASS PER ASTM-B16, UNS C36000.
- 1.4 LOCK RING: BERYLLIUM COPPER PER ASTM-B197, UNS C17200.
- 1.5 GASKET & O-RINGS: SILICONE RUBBER PER A-A-59588.
- 1.6 MITER INSULATOR(S): PTFE FLUORCARBON PER ASTM-D1710, TYPE 1, GRADE 1, CLASS A.
- 1.7 DIEL. BEAD(S): POLYTHERMIDE THERMOPLASTIC (ULTEM 1000) PER ASTM-D5205.

2.0 FINISHES:

- 2.1 CENTER CONTACT: GOLD PLATE PER ASTM-B488, 50 MICROINCHES MIN. THK. OVER ELECTROLYTIC NICKEL PLATE PER ASTM-B689, 50 MICROINCHES MIN. THK.
- 2.2 BODY, COUPLING & CLAMP NUTS: PASSIVATE PER SAE-AMS-2700.
- 2.3 GASKET, INSULATOR, LOCK RING, & DIELECTRICS: NONE.

- 3.0 INTERFACE: SMA PLUG PER PCI INTERFACE SPECIFICATION PCI-SMAP (MEETS MIL-STD-348, FIG. 310-1). COUPLING NUT HAS ϕ .016 MIN LOCKWIRE HOLES (3) PLACES.



TOLERANCES UNLESS OTHERWISE SPECIFIED	DRAWN BY: MJK	PART DESC.: SMA RT. ANGLE PLUG, SOLDER CLAMP FOR HARBOUR LL335i CABLE			
	DATE: 06/23/14	SCALE	SHEET NO.	DRAWING NUMBER	REV
.XX ± .02	CAGE CODE	2:1	1 OF 1	3557-0L	A
.XXX ± .005	4MJR5				
.XXXX ± .0005					
ANGLES ± 2°					