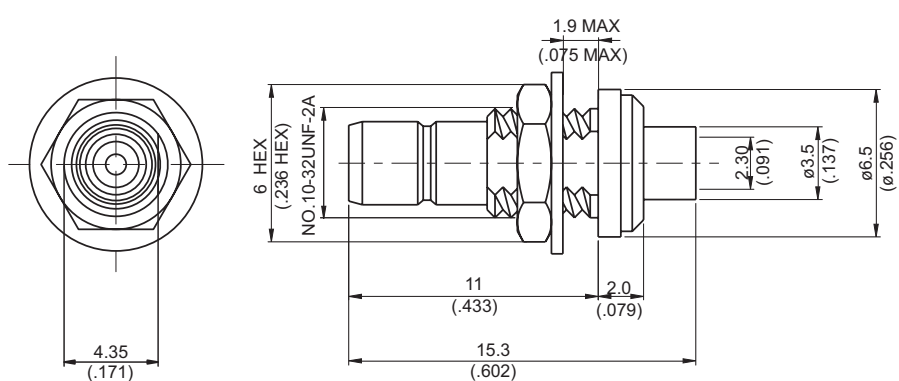
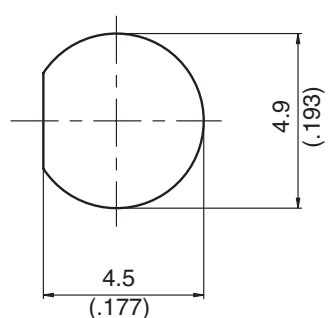

SMB8305-0085	SMB Jack Solder For Bulkhead 50Ω																					
 <p style="text-align: center;">MOUNTING HOLE :</p> 																						
<table border="1" style="width: 100%; border-collapse: collapse; text-align: center;"> <thead> <tr> <th style="width: 15%;">Parts</th> <th style="width: 15%;">Material</th> <th style="width: 70%;">Plating (Micro-inch)</th> </tr> </thead> <tbody> <tr> <td>Hex Nut</td> <td>Brass</td> <td>Gold 5 Over Nickel 50 Over Copper 50</td> </tr> <tr> <td>Lock Washer</td> <td>Brass</td> <td>Gold 5 Over Nickel 50 Over Copper 50</td> </tr> <tr> <td>Contact Pin</td> <td>Brass</td> <td>Gold 20 Over Nickel 50 Over Copper 50</td> </tr> <tr> <td>Insulator</td> <td>Teflon</td> <td></td> </tr> <tr> <td>Barrel</td> <td>Brass</td> <td>Gold 5 Over Nickel 50 Over Copper 50</td> </tr> <tr> <td>Body</td> <td>Brass</td> <td>Gold 5 Over Nickel 50 Over Copper 50</td> </tr> </tbody> </table>		Parts	Material	Plating (Micro-inch)	Hex Nut	Brass	Gold 5 Over Nickel 50 Over Copper 50	Lock Washer	Brass	Gold 5 Over Nickel 50 Over Copper 50	Contact Pin	Brass	Gold 20 Over Nickel 50 Over Copper 50	Insulator	Teflon		Barrel	Brass	Gold 5 Over Nickel 50 Over Copper 50	Body	Brass	Gold 5 Over Nickel 50 Over Copper 50
Parts	Material	Plating (Micro-inch)																				
Hex Nut	Brass	Gold 5 Over Nickel 50 Over Copper 50																				
Lock Washer	Brass	Gold 5 Over Nickel 50 Over Copper 50																				
Contact Pin	Brass	Gold 20 Over Nickel 50 Over Copper 50																				
Insulator	Teflon																					
Barrel	Brass	Gold 5 Over Nickel 50 Over Copper 50																				
Body	Brass	Gold 5 Over Nickel 50 Over Copper 50																				
<p>Weight: 1.36 g Suitable Cables: Semi-rigid.085</p>																						

This part number complies with RoHS.
Notice: JYEBAO reserves the right to make modifications deemed appropriate.

CABLE ASSEMBLY INSTRUCTION

SMB8305-0085

JYE BAO CO., LTD.

A

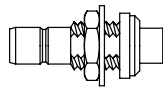

BODY+HEX NUT
+LOCK WASHER

B



CONTACT PIN

DIAGRAM

ASSEMBLY INSTRUCTION

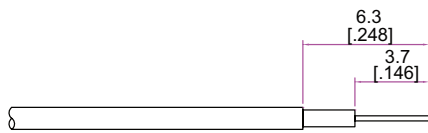

Step 1: STRIP AS SHOWN.
(OUTER CONDUCTOR 6.3MM ; DIELECTRIC 3.7MM)

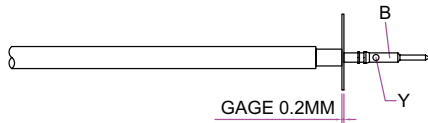

Step 2: PUT 0.20 MM GAGE IN PLACE, INSERT CABLE'S
CENTER CONDUCTOR INTO CENTER PIN AND
SOLDER IN "Y".

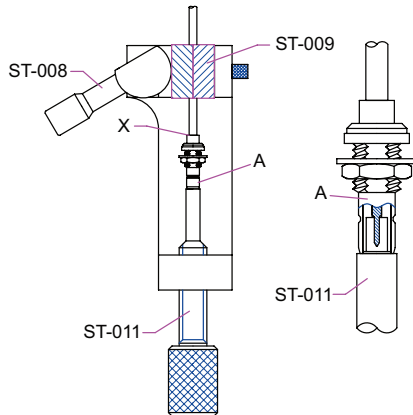

Step 3: INSERT PREPARED CABLE INTO SOLDERING
FIXTURE " ST-008 ". USE INSERT TOOL " ST-009 "
AND LOCATOR TOOL " ST-011 " TO FIX THE
CONNECTOR . SOLDER IN " X " .

This part number complies with RoHS.

Notice: JYEBAO reserves the right to make modifications deemed appropriate.