

**STRAIGHT PLUG SOLDER TYPE
CABLE .085**

R117.053.807
SERIES SMB-LOCK

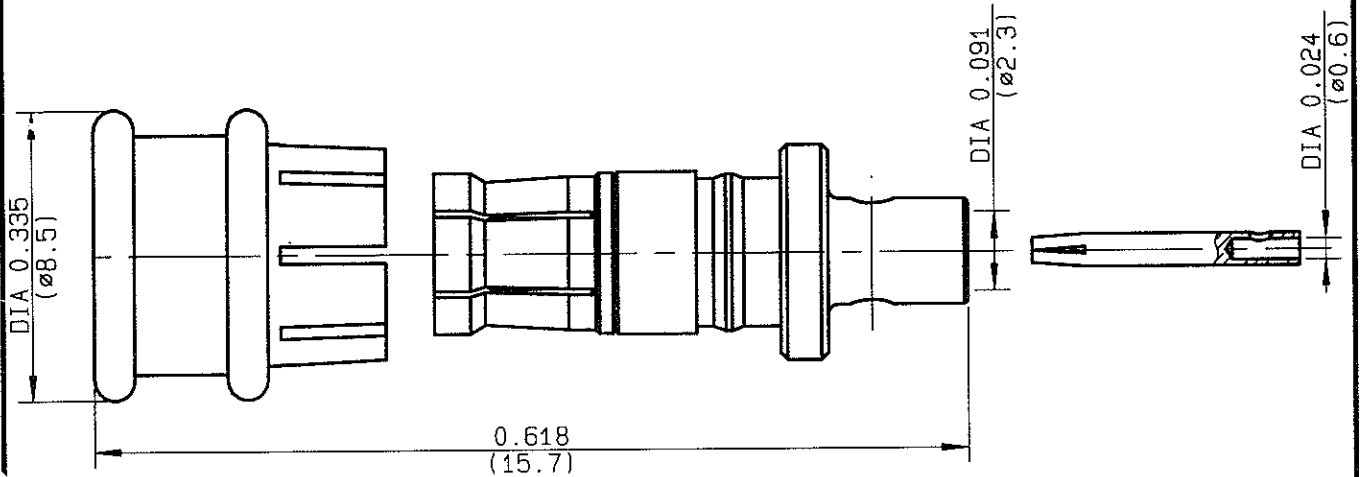

NOMINAL IMPEDANCE	50 Ω	CABLES : KS 1
FREQUENCY RANGE	0-4 GHz	RS 405
TEMPERATURE RATING	-35/+125 °C	
V.S.W.R	1.1 + .025 x F(GHz)Maxi	
RF INSERTION LOSS	.2 \sqrt{F} (GHz) dB Maxi	
VOLTAGE RATING	335 Veff Maxi	
DIELECTRIC WITHSTANDING VOLTAGE	750 Veff Mini	
INSULATION RESISTANCE	1000 M Ω Mini	OTHERS CHARACTERISTICS
HERMETIC SEAL	NA Atm.cm ³ /s	CABLE RETENTION
LEAKAGE (pressurized only)	NA	220 N Mini
MECHANICAL DURABILITY	500 Cycles	CENTER CONTACT RETENTION
WEIGHT	1.35 gr	Axial force - mating end
SPECIFICATION		NA N Mini
		Axial force - opposite end
		NA N Mini
		Torque
		NA cm.N Mini
		RECOMMENDED TORQUES
		Mating
		NA cm.N
		Panel nut
		NA cm.N
		Clamp nut
		NA cm.N

CONNECTOR PARTS	MATERIALS	FINISH	(all values are given in micrometers)
BODY	BRASS	BBR 2	
OUTER CONTACT	BRONZE	BBR 2	
CENTER CONTACT	BERYLLIUM COPPER	GOLD 0.8 OVER COPPER 0.5	
INSULATOR	PTFE	-	
GASKET		-	
OTHERS PIECES	DELTRIN (POM)		

ISSUE	CREATION DATE	FILE PART-NUMBER
9843A02	09-DEC-97	EPC 97-08



The information given here is subject to change without notice. Design changes may be in order to improve the product.

Connect to the future

GUE...N



RADIALL®

R117.053.807

ISSUE 9843A02

SERIES SMB-LOCK

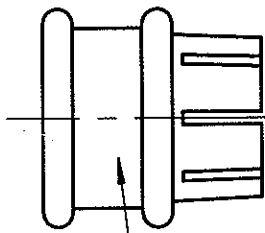

COUPLING NUT

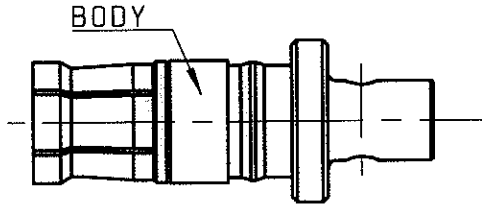

BODY

CENTER CONTACT

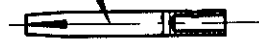

We recommend a thermal preconditioning cable .

①

Strip off the outer conductor and the dielectric.

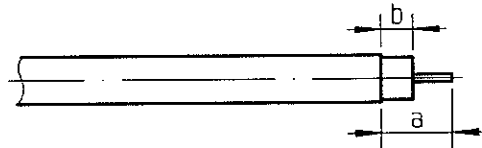

Stripping	a	b	c	d	e
inch	0.118	0.039	0	0	0
mm	3	1			

②

- Solder the center contact on the inner conductor of the cable.

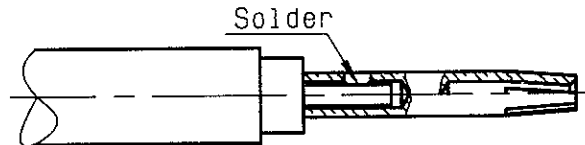

②

- Put the assembly into the body
 - Solder the body on the semi-rigid cable.

- NOTE : In order to ensure a correct positioning of the center contact, it is recommended that a receptacle is fitted to the plug prior to solder the body and tighten the assembly in the assembly jig R282.740.000

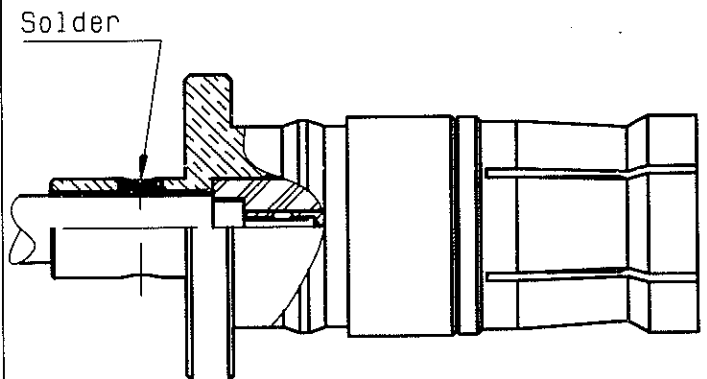



RADIALL®

R117.053.807

ISSUE 9843A02

SERIES
SMB-LOCK

④

- Put the coupling nut on the Ref. plane.
- Insert the body into the coupling nut
(In direction F).

