

ISOMETRIC VIEWS
OF CONNECTOR
REFERENCE ONLY
SCALE: 2:1

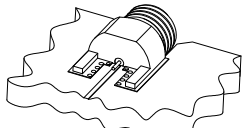

ISOMETRIC VIEWS OF
CONNECTOR MOUNTED
REFERENCE ONLY
SCALE: 2:1

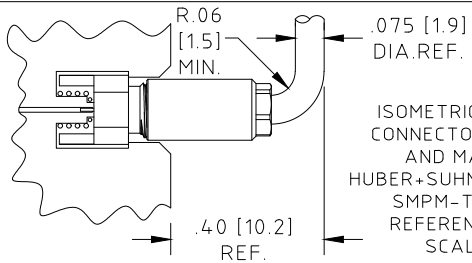

ISOMETRIC VIEWS OF
CONNECTOR MOUNTED
AND MATED TO
HUBER+SUHNER Astrolab
SMPM-T FEMALE
REFERENCE ONLY
SCALE: 2:1

NOTES:

1. DESCRIPTION

LAUNCHER, EDGE MOUNT, SMPM-T MALE,
THREADED HUBER+SUHNER Astrolab SMPM MALE.
FULL DETENT OPTION SHOWN
SEE CHART FOR OPTIONS AND PART NUMBERS.

2. MATERIALS AND FINISHES

BODY AND CENTER CONDUCTOR,
BERYLLIUM COPPER ALLOY PER ASTM B-196,
UNS No. C17300, TEMPER TD04(H),
GOLD PLATED .000050 IN (1.27 μm) MIN. THK.
PER ASTM B-488, CODE C,
TYPE II, CLASS 1.27

OVER
NICKEL PLATE, .000050 IN (1.27 μm) MIN. THK.
PER SAE-AMS-QQ-N-290, TYPE 1.

DIELECTRIC,
POLYTETRAFLUOROETHYLENE (PTFE) PER
ASTM D-1710, OR ASTM D-4894,
TYPE I, GRADE 1.

3. ELECTRICAL CHARACTERISTICS:

IMPEDANCE, 50.0 Ohms NOMINAL.
FREQUENCY, 65.0 GHz.

4. INTERFACE DEFINITION, SMPM MALE IS DESIGNED AND
MANUFACTURED IAW MIL-STD-348 AND WILL MATE
WITH SMPM FEMALE CONNECTOR THAT IS DESIGNED
AND MANUFACTURED IAW MIL-STD-348.

5. OPERATING TEMPERATURE RANGE:
-55° C TO +125° C.

6. MOUNTING PATTERNS:

CUSTOMER SPECIFIC FACTORS INCLUDING TRANSMISSION LINE TOPOLOGY,
SUBSTRATE THICKNESS AND MATERIAL, BOARD-STACKUP, OPERATING
FREQUENCY, ETC. MUST BE SUBMITTED TO HUBER+SUHNER Astrolab
FOR ANALYSIS PRIOR TO RELEASE OF FINAL PERFORMANCE LEVELS
AND MOUNTING CONFIGURATION.

7. ESTIMATED WEIGHT: 0.41 GRAMS

CONTROL DRAWING

29976BM-x-006

M

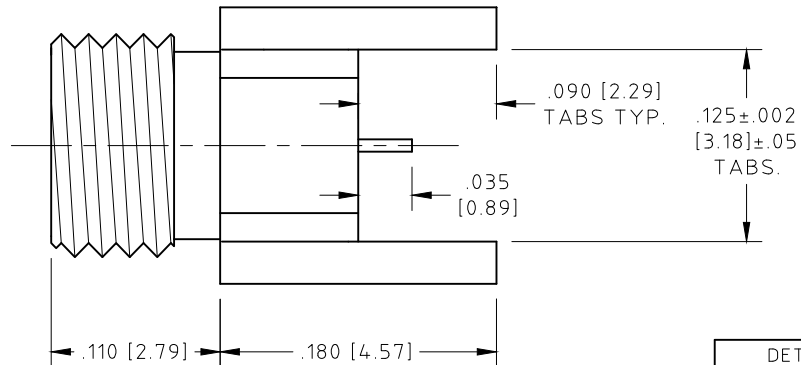
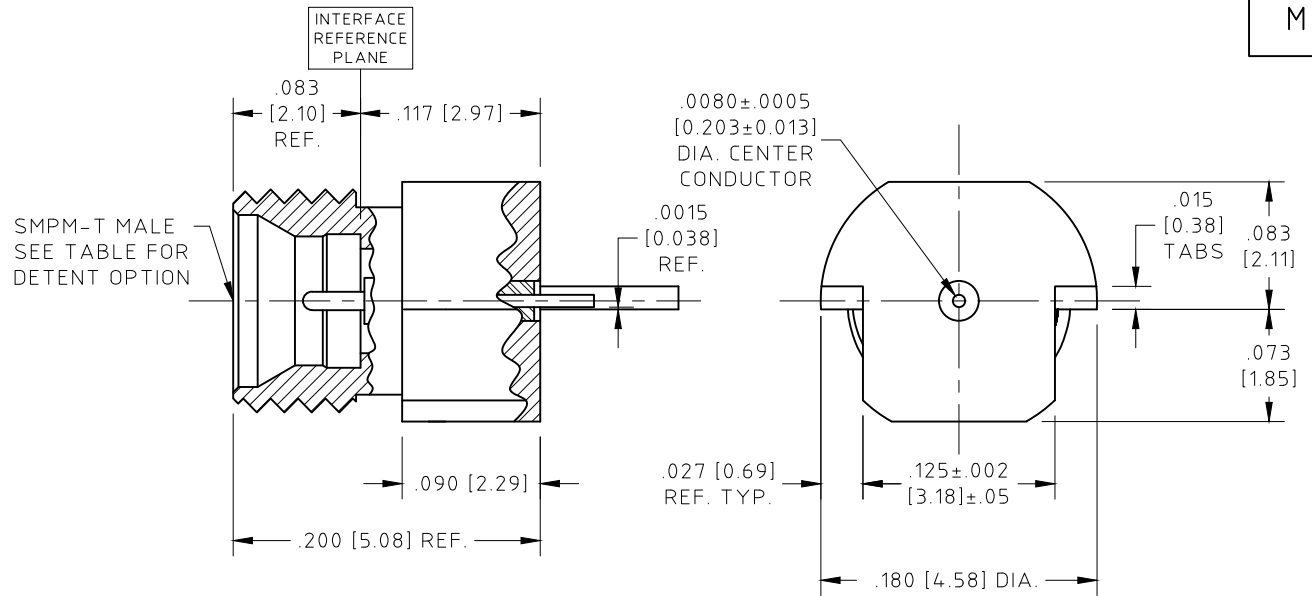

DETENT	PART NUMBER
FULL DETENT	29976BM-2-006
SMOOTH BORE	29976BM-4-006

NAME	DATE		
PREP. GSG	12/07/11		
ELEC. RF	12/07/11		
MECH. AW	12/08/11		
Q.C.		SCALE	ANSI A



THIS DRAWING CONTAINS PATENTABLE AND PROPRIETARY INFORMATION. THE DESIGN CANNOT BE USED WITHOUT WRITTEN PERMISSION OF HUBER + SUHNER ASTROLAB.

UNLESS OTHERWISE SPECIFIED CONCENTRICITY .004 T.I.R. CORNERS AND FILLETS .005 MAX. RADIUS OR CHAMFER. SURFACE FINISH 63 RMS MICROINCHES OR BETTER	
X	±.030 [±0.762]
XX	±.015 [±0.381]
XXX	±.005 [±0.127]
XXXX	±.0005 [±0.013]
ANGLES	± 1°
DO NOT SCALE DRAWING	

TITLE		CODE IDENT.	DWG NO.	REV.	SHEET
SMPM-T MALE, PC BOARD MOUNT CONNECTOR		16301	DWG-01014736	M	1
THDS. TO BE IN ACCORD WITH U.S. DEPT. OF COMM. SCREW THD. STDS. FOR FEDERAL SERVICES 1950 SUPL. TO HANDBOOK H 28.					

M	ECN No. 21379	07/29/20	GS	GSG
REV.	DESCRIPTION	DATE	BY	APPROVED