

CATALOG NUMBER

H055-A12-01

MATERIAL AND FINISH

PLUG HOUSING, CAP,
FLANGE, SPRING RING
AND BUSHING:

CRES 303; PASSIVATED

CENTER CONTACT
AND TRANSITION:BeCu; GOLD PLATE 50-100 MICRONS
OVER NICKEL PLATE 50 MICRONS MIN.

DIELECTRIC:

VIRGIN PTFE

SPRING:

17-7 STAINLESS STEEL

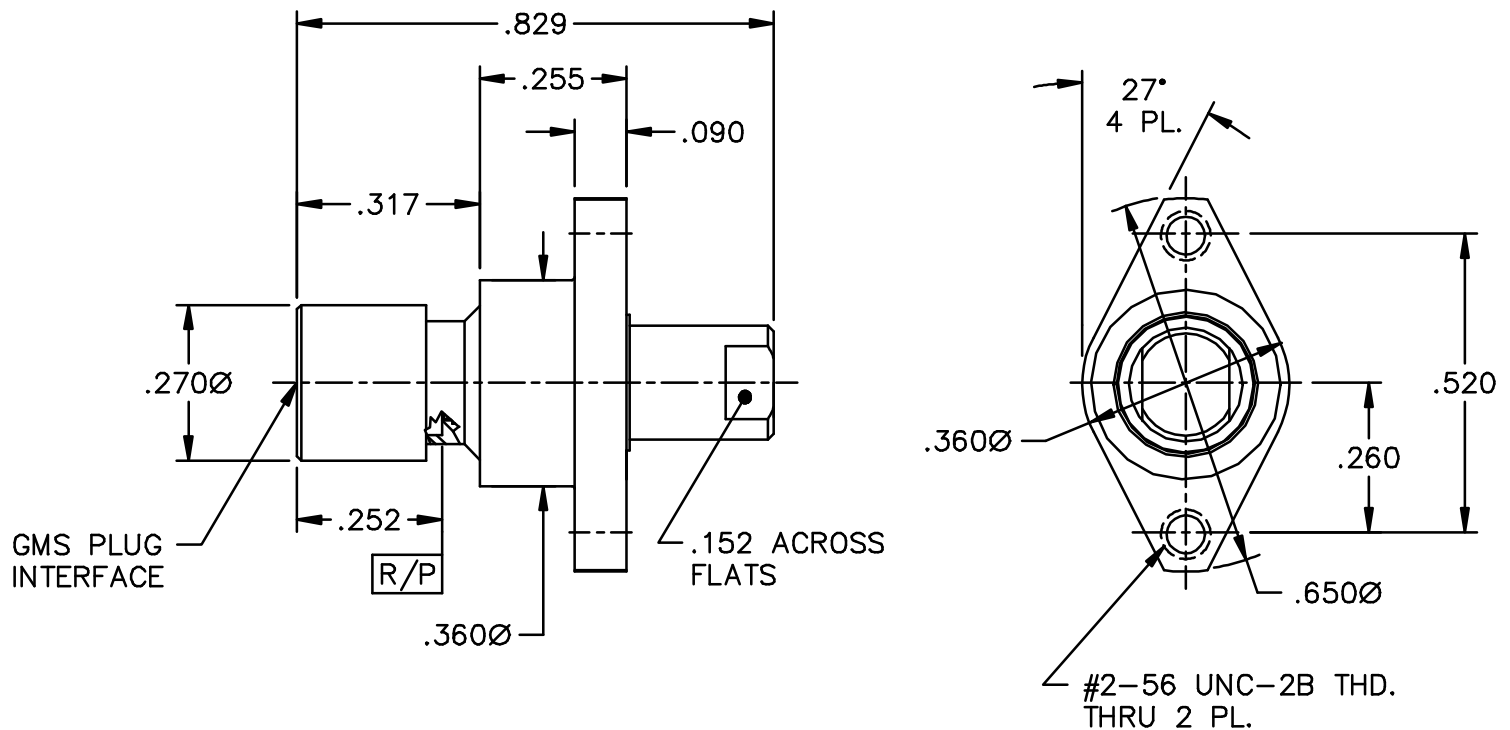
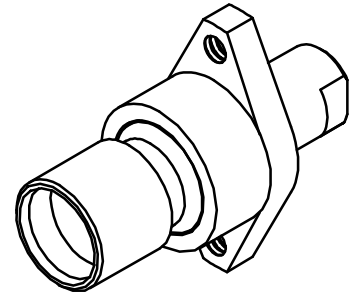

NOTE:

1. VSWR <math>< 1.15:1 @ 18 \text{ GHz}</math>, <math>< 1.35:1 @ 23 \text{ GHz}</math>.

This drawing and any data contained herein is the property of Corning Gilbert Inc., and constitutes and contains proprietary and confidential information. Neither receipt nor possession of this drawing confers or transfers any right to duplicate, use or disclose any information contained herein except as expressly authorized by Corning Gilbert Inc.

GMS PLUG FLOAT
MOUNT 50 OHM LOADIDENT CODE:
82316

REVISION: A

Corning Gilbert Inc.

SOURCE FILE: MECR# 2597

DWG. NO.: OL-H055-A12-01

ASSY. PROC.: —