

DATE REVISED: 8/23/06

CATALOG NUMBER

A055-A11-02

MATERIAL AND FINISH

CENTER CONTACT, LOAD BeCu: GOLD PLATE 50-100 MICRONS
HOUSING, ANTI-ROCK/EMI OVER NICKEL PLATE 50 MICRONS MIN.
RING AND END CAP: VIRGIN PTFE
DIELECTRIC: VIRGIN PTFE
MAX. AVERAGE POWER: .25 WATTS

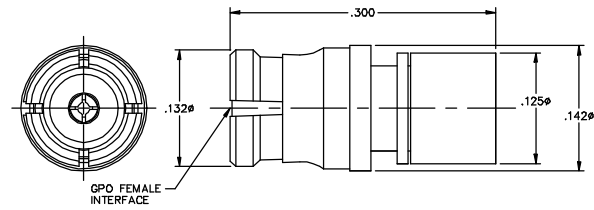
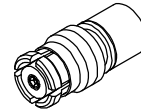

This drawing and any data contained herein is the property of Corning Gilbert Inc., and constitutes and contains proprietary and confidential information. Neither receipt nor possession of this drawing confers or transfers any right to duplicate, use or disclose any information contained herein except as expressly authorized by Corning Gilbert Inc.

GPO FEMALE LOAD FIELD GRADE TERMINATION	IDENT CODE: 82316	Corning Gilbert Inc.
	REVISION: H	
SOURCE FILE: SK-1800	DWG. NO.: OL-A055-A11-02	ASSY. PROC.: -