

CATALOG NUMBER

BB014-DP1-01

MATERIAL AND FINISH

CENTER CONTACT: BeCu; GOLD PLATE 75 MICROINCHES TYPICAL
OVER NICKEL PLATE 100 MICROINCHES TYPICAL

HOUSING: ABS; GOLD PLATE 5 MICROINCHES MINIMUM
OVER NICKEL PLATE 100 MICROINCHES TYPICAL

DIELECTRIC: VIRGIN PTFE

CRIMP RING: BRASS; GOLD PLATE 75 MICROINCHES TYPICAL
OVER NICKEL PLATE 100 MICROINCHES TYPICAL

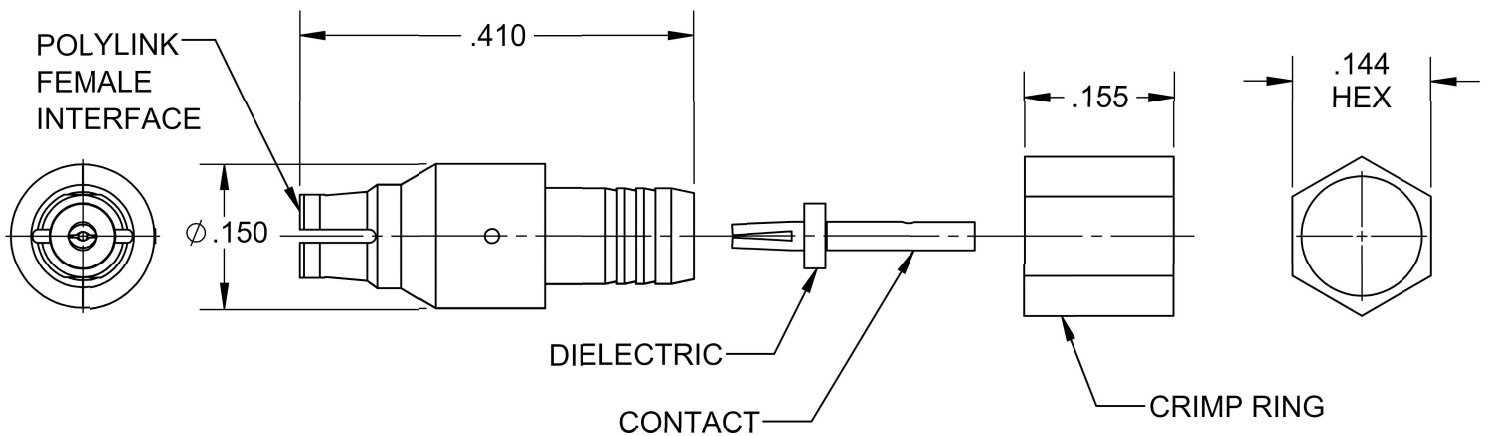
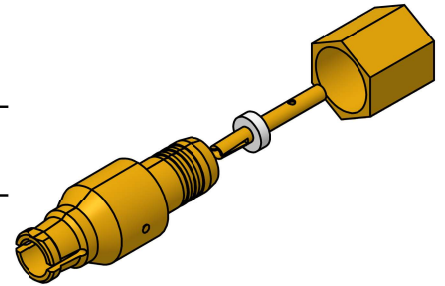

CORNING RESTRICTED - This drawing and any data contained herein is the proprietary and confidential information of Corning. Neither receipt nor possession of this drawing provides any right to duplicate, use, or disclose any information contained herein except with the express written consent of Corning.
EXPORT CONTROL - This document contains information within the purview of the Export Administration Regulations (EAR), 15 CFR 730-774, and may be export controlled.

APPROX. WEIGHT:	0.5270 grams	SIGNATURES	INIT	DATE:
TOLERANCE: .XX ±.010 .XXX ±.005 ANGULAR ±5°		DRAWN:	BLK	2/4/24
		CHECKED:	MJC	
		APPROVED:	TEF	

POLYLINK FEMALE STRAIGHT TO .086 S/R CABLE	CAGE CODE: 82316	SCALE: 5:1	CORNING	PLANT OF ORIGIN CORNING PHOENIX PLANT: (623)245-1050 CUSTOMER SERVICE: (800) 651-8869
	REVISION:	01		

SOURCE FILE:	OP #28670	DWG. NO.:	OL-BB014-DP1-01	ASSY. PROC.:	AP20-001
---------------------	-----------	------------------	-----------------	---------------------	----------